



**Hard Rock - Atlantic City**

Exterior - Site Signage

Atlantic City, New Jersey

February 15, 2018

BID SET

2017024.00

Kiku Obata & Company  
6161 Delmar Blvd., Suite 200  
St. Louis, MO 63112  
Office 314.361.3110  
Fax 314.361.4716  
www.kikuobata.com

Owner:  
Hard Rock International

Client:  
SOSH Architects  
1020 Atlantic Avenue  
Atlantic City, NJ 08401  
609-345-5222

Authorized Use:  
**Bid Set**

Issue Date: February 15, 2018

Revisions:			
No.	Date	Description	Drawn By
1	-	-	
2	-		
3	-		
4	-	-	
5	-		
6	-	-	
7	-		
8	-		
9	-	-	
10	-		

All reproduction and intellectual  
property rights reserved.  
© 2018 Kiku Obata & Company

**Hard Rock Hotel & Casino  
Atlantic City**  
1000 Boardwalk  
Atlantic City, NJ 08401

Project Number: 2017024.00

Drawing List

Drawn by: JR/LM      **SG-20-0-E01**  
Checked by: LM/KO

Drawing List

SG-20-0-E SERIES  
General

- 0-E01    Drawing List
- 0-E02    Fonts, Glyphs, Materials & Finishes

SG-20-3-E SERIES  
Sign Drawings

- 3-E01    Type AA, Vehicle Directional
- 3-E02    Type AA, Vehicle Directional - Messages
- 3-E03    Type BB, Self Park Blade
- 3-E04    Type BB, Self Park Blade
- 3-E05    Type BB, Self Park Blade
- 3-E06    Type CC, Self Park ID at Entrance
- 3-E07    Type CC, Self Park ID at Entrance
- 3-E08    Type CC1, VIP Parking ID at Entrance
- 3-E09    Type CC1, VIP Parking ID at Entrance
- 3-E10    Type DD, VIP Parking Directional
- 3-E11    Type DD, VIP Parking Directional
- 3-E12    Type EE, Vehicle Directional - Column
- 3-E13    Type EE, Vehicle Directional - Column - Messages
- 3-E14    Building Entry Plan - Signs - Reference Views
- 3-E15    Type FF, Building Entry ID
- 3-E16    Type FF, Building Entry ID
- 3-E17    Type FF, Building Entry ID
- 3-E18    Type FF, Building Entry ID
- 3-E19    Type GG, Curbside Information
- 3-E20    Type GG, Curbside Information
- 3-E21    Type GG, Curbside Information - Detailed Locations
- 3-E22    Type HH, Vehicular Regulatory
- 3-E23    Type HH, Vehicular Regulatory
- 3-E24    Type JJ1, Do Not Enter - Type LL, Do Not Enter
- 3-E25    Type JJ1, Do Not Enter - Type JJ2, Deliveries Only -  
Type JJ3, Do Not Enter - Type KK (Bang Bar) -  
Type LL, Do Not Enter
- 3-E26    Type JJ4, Deliveries Only - Type KK (Bang Bars)
- 3-E27    Type JJ1, JJ2, JJ3, & JJ4 - Details
- 3-E28    Type KK & LL - Details
- 3-E29    Type MM, Hard Rock Logo on Building
- 3-E30    Type NN, Hard Rock Logo on Portals

SG-20-10-E SERIES  
Performance Specifications

- 10-E01    Specifications
- 10-E02    Specifications
- 10-E03    Specifications
- 10-E04    Specifications
- 10-E05    Specifications
- 10-E06    Specifications
- 10-E07    Specifications
- 10-E08    Specifications

SG-20-2-E SERIES  
Locations Plans

Separate 36x48 document

Kiku Obata & Company  
6161 Delmar Blvd., Suite 200  
St. Louis, MO 63112  
Office 314.361.3110  
Fax 314.361.4716  
www.kikuobata.com

Owner:  
Hard Rock International

Client:  
SOSH Architects  
1020 Atlantic Avenue  
Atlantic City, NJ 08401  
609-345-5222

Authorized Use:  
**Bid Set**

Issue Date: February 15, 2018

Revisions:			
No.	Date	Description	Drawn By
1	-	-	
2	-		
3	-		
4	-	-	
5	-		
6	-	-	
7	-		
8	-		
9	-	-	
10	-		

All reproduction and intellectual  
property rights reserved.  
© 2018 Kiku Obata & Company

**Hard Rock Hotel & Casino  
Atlantic City**  
1000 Boardwalk  
Atlantic City, NJ 08401

Project Number: 2017024.00

Sign Quantity: **00**

**Fonts, Glyphs, Materials  
& Finishes**

Drawn by: JR/LM **SG-20-0-E02**  
Checked by: LM/KO

Apex New Medium

A B C D E F G H I J K L M N O P Q R S T U V W X Y Z

Tillium Web Regular

1 2 3 4 5 6 7 8 9 0

Tillium Web SemiBold

1 2 3 4 5 6 7 8 9 0

Trade Gothic LT Std - Bold Condensed No. 20

A B C D E F G H I J K L M N O P Q R S T U V W X Y Z  
1 2 3 4 5 6 7 8 9 0

Arrows



Graphics

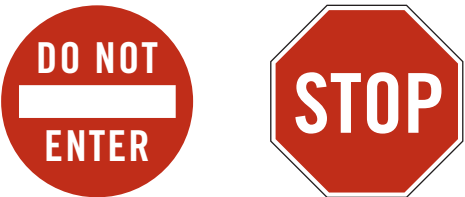

Materials and Finishes

Paint Colors



**P1**  
Matthews®  
Anchor Bronze  
Metallic Satin  
MP46305

**P2**  
Matthews®  
Leonardo Bronze  
Metallic Satin  
MP49025

**P3**  
Matthews®  
Touch O Bronze  
Metallic Satin  
MP41254

**P4**  
Matthews®  
Sunny White  
Satin  
MP04446

Acrylic

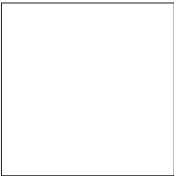

**A1**  
Plexiglas®  
Translucent White  
7328 White

Vinyl



**V1**  
3M™ Scotchlite  
Reflective Graphic Film  
White  
680-10

**V2**  
3M™ Scotchlite  
Reflective Graphic Film  
Yellow  
680-71

**V3**  
3M™ High Intensity  
Prismatic Reflective  
Sheeting  
3932 Red

**V4**  
3M™ Scotchlite  
Reflective Graphic Film  
Brown  
5100-79

- General Notes:**
- Electric to be pulled to locations by others. Sign Contractor is responsible for electrical hook up.
  - All lighting to be internal LED with no light leaks. Vents shall be shielded to prevent light leak.
  - Internal lighting to be even across all messages with no hot or cool spots.
  - Lighting color temperature to be \_\_\_\_K
  - All footings to be provided by GC. Sign Contractor to coordinate with GC on structural requirements.
  - Field verify all locations for proper power and footings.

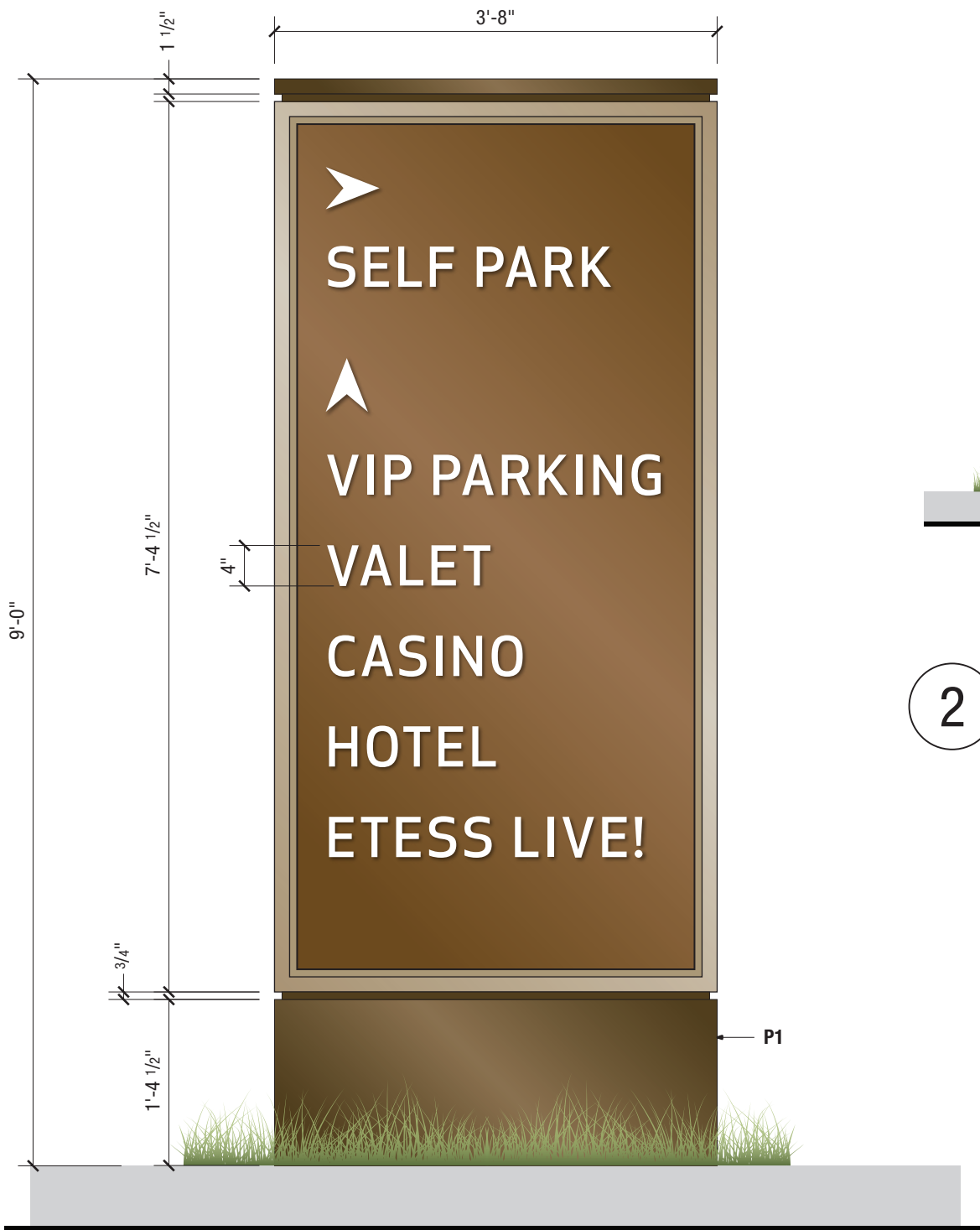

**1** ELEVATION  
SCALE: 3/4"=1'-0"

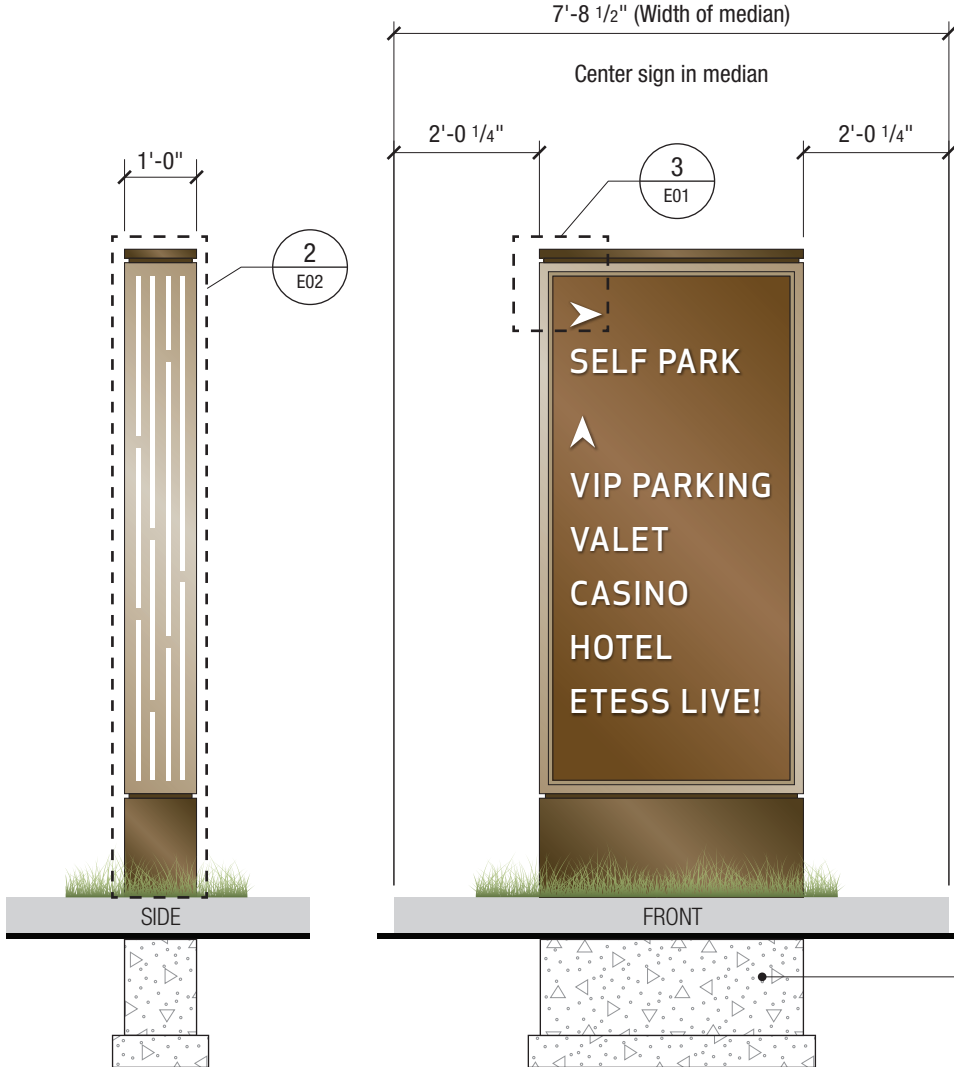

**2** ELEVATION  
SCALE: 3/8"=1'-0"

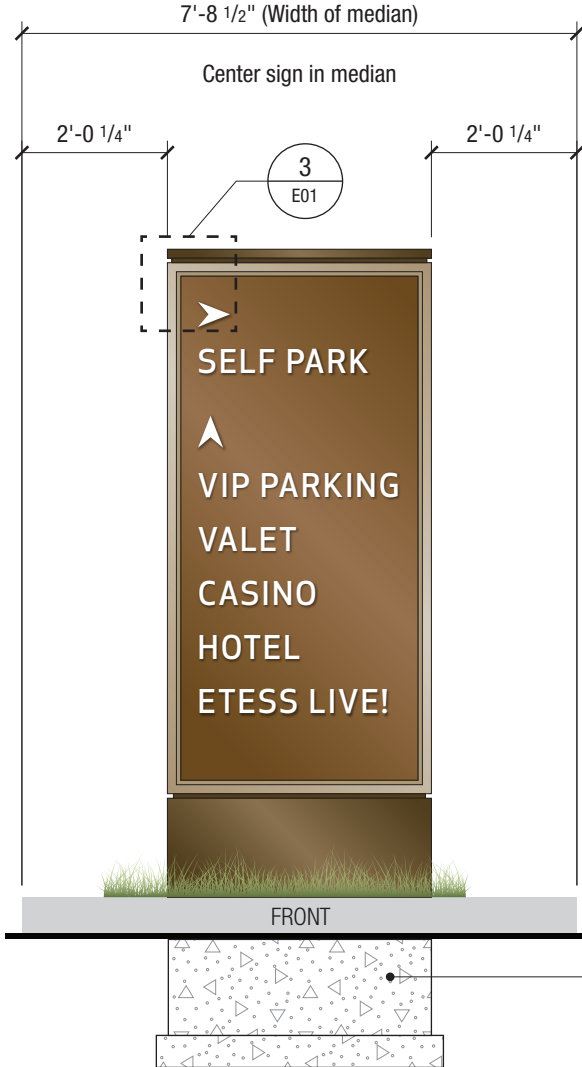
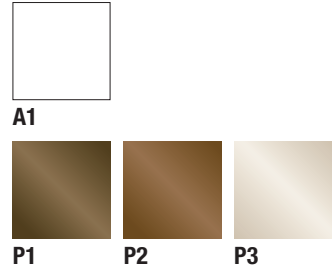

**3** ELEVATION  
SCALE: 1 1/2"=1'-0"

**Push Through Acrylic**  
All push-through acrylic shall be cut true to the letter, glyph and symbol forms - rounded corners will not be acceptable. Push-through acrylic shall be proud of the sign panel face by no less than 1/8" and no more than 1/4"

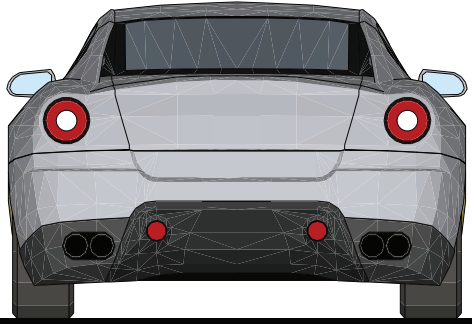

Sign Contractor's structural engineer to submit signed and sealed engineered drawings of footings and sign structures  
**Allow for power to come up through footing and into the interior of the sign cabinet.**

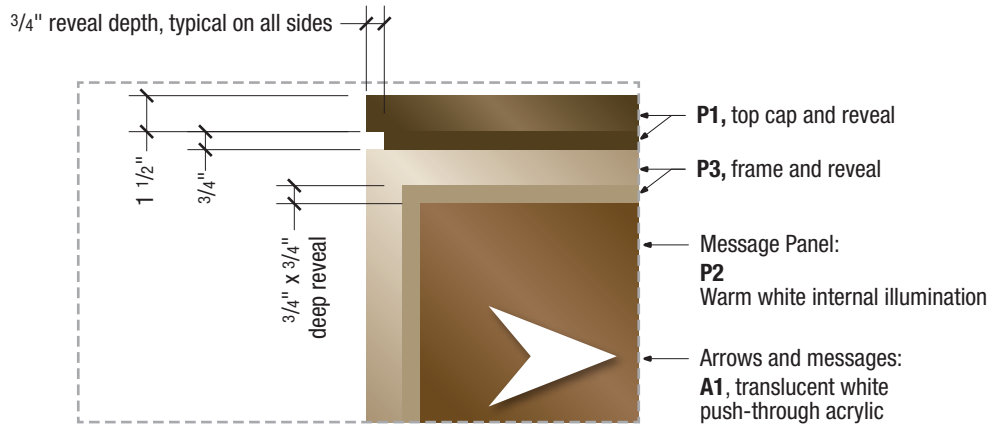

# KIKU OBATA

Kiku Obata & Company  
6161 Delmar Blvd., Suite 200  
St. Louis, MO 63112  
Office 314.361.3110  
Fax 314.361.4716  
www.kikuobata.com

Owner:  
Hard Rock International

Client:  
SOSH Architects  
1020 Atlantic Avenue  
Atlantic City, NJ 08401  
609-345-5222

Authorized Use:  
**Bid Set**

Issue Date: February 15, 2018

Revisions:			
No.	Date	Description	Drawn By
1	-	-	
2	-	-	
3	-	-	
4	-	-	
5	-	-	
6	-	-	
7	-	-	
8	-	-	
9	-	-	
10	-	-	

All reproduction and intellectual property rights reserved.  
© 2018 Kiku Obata & Company

**Hard Rock Hotel & Casino  
Atlantic City**  
1000 Boardwalk  
Atlantic City, NJ 08401

Project Number: 2017024.00

Sign Quantity: **04**

**Type AA  
Vehicle Directional**

Drawn by: JR/LM **SG-20-3-E01**  
Checked by: LM/KO

\* All messages to be confirmed and approved by Owner

\* Artwork for all messages to be provided by KO

Location AA-01

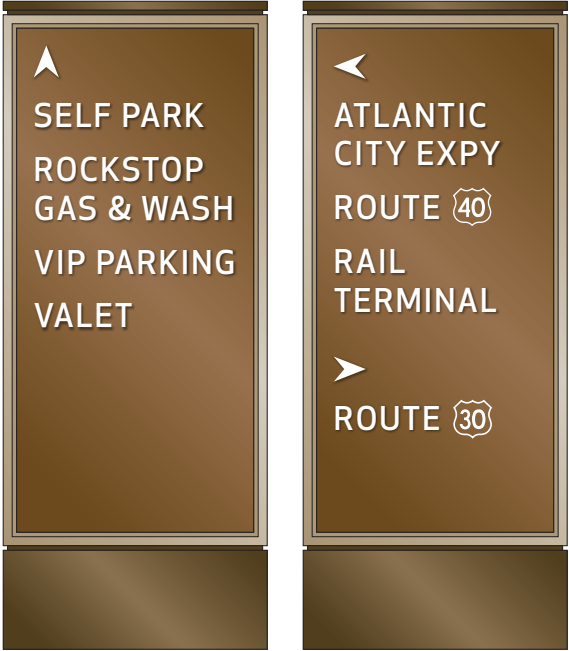

North Face

South Face

Location AA-02

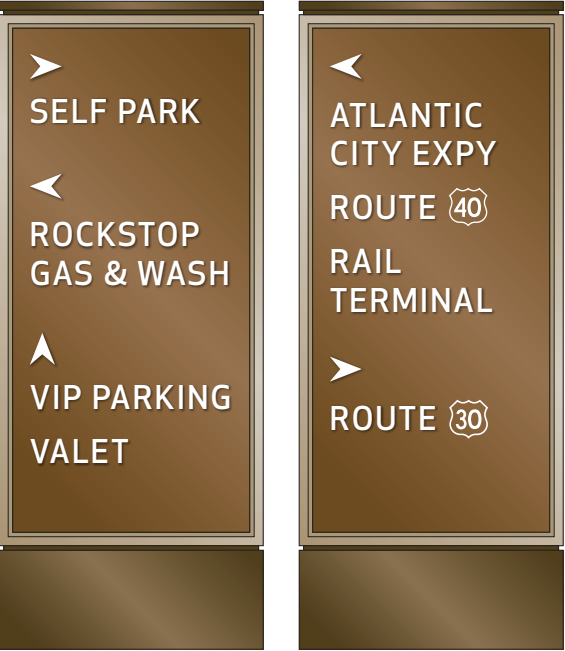

North Face

South Face

Location AA-09



North Face

South Face

Location AA-10

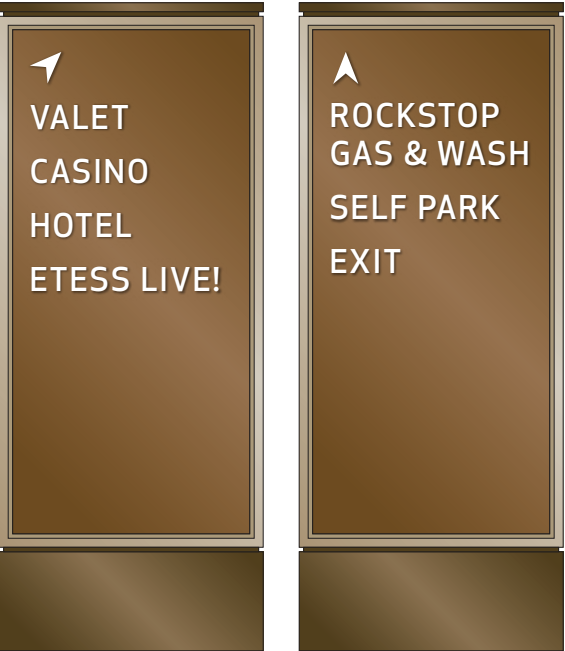

North Face

South Face

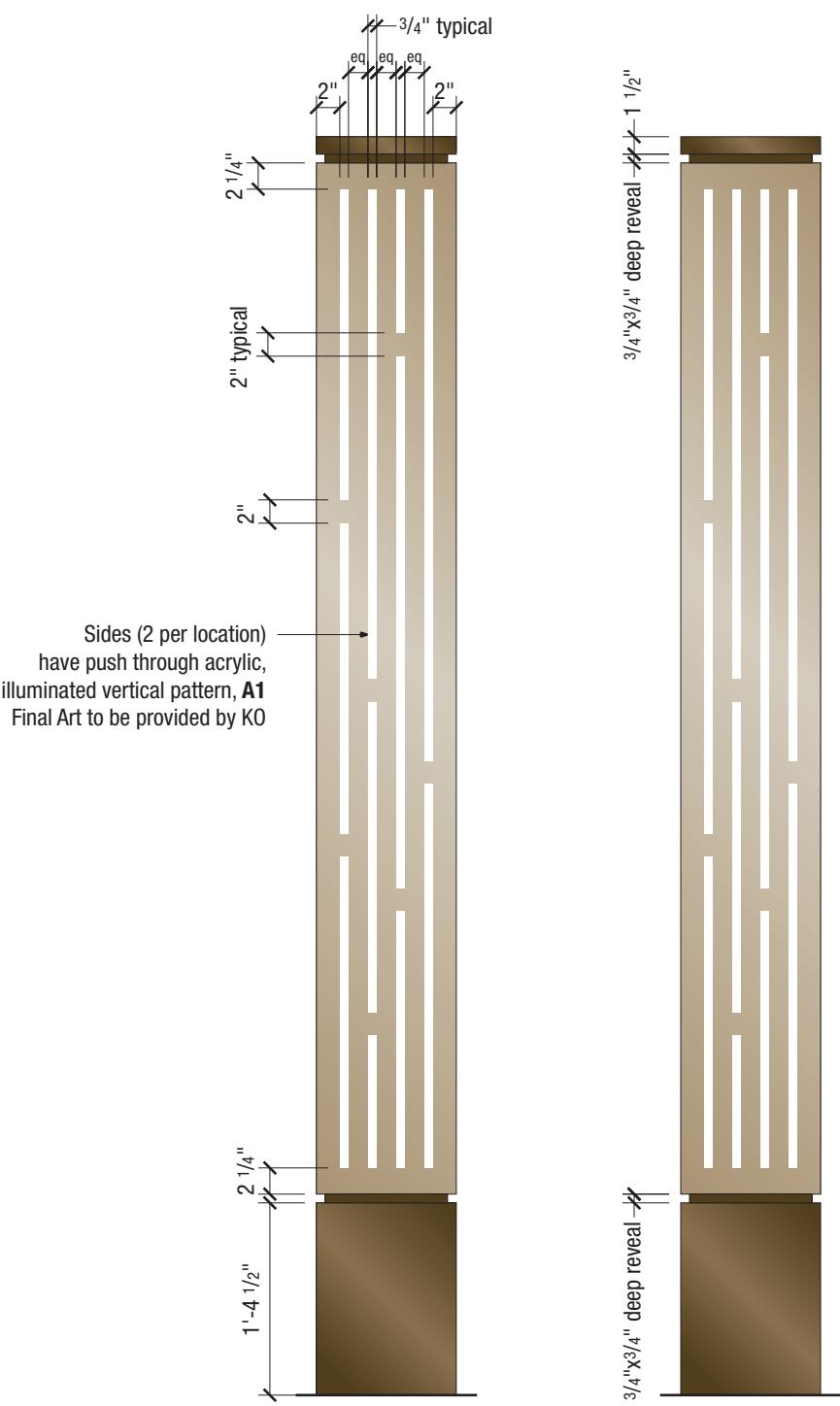

East Face

West Face

Typical detail on returns at all locations

KIKU OBATA

Kiku Obata & Company  
6161 Delmar Blvd., Suite 200  
St. Louis, MO 63112  
Office 314.361.3110  
Fax 314.361.4716  
www.kikuobata.com

Owner:  
Hard Rock International

Client:  
SOSH Architects  
1020 Atlantic Avenue  
Atlantic City, NJ 08401  
609-345-5222

Authorized Use:  
Bid Set

Issue Date: February 15, 2018

Revisions:			
No.	Date	Description	Drawn By
1	-	-	
2	-		
3	-		
4	-	-	
5	-		
6	-	-	
7	-		
8	-		
9	-	-	
10	-		

All reproduction and intellectual  
property rights reserved.  
© 2018 Kiku Obata & Company

Hard Rock Hotel & Casino  
Atlantic City  
1000 Boardwalk  
Atlantic City, NJ 08401

Project Number: 2017024.00

Sign Quantity: 04

Type AA  
Vehicle Directional - Messages

Drawn by: JR/LM  
Checked by: LM/KO

SG-20-3-E02



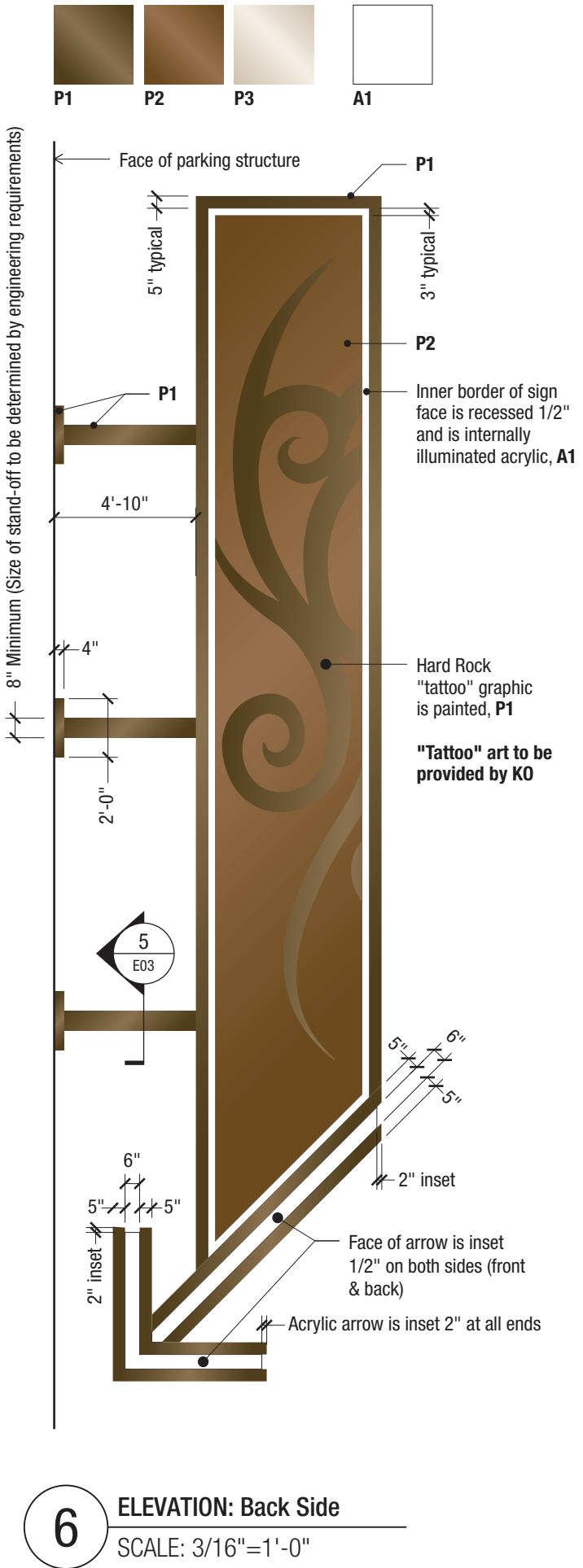
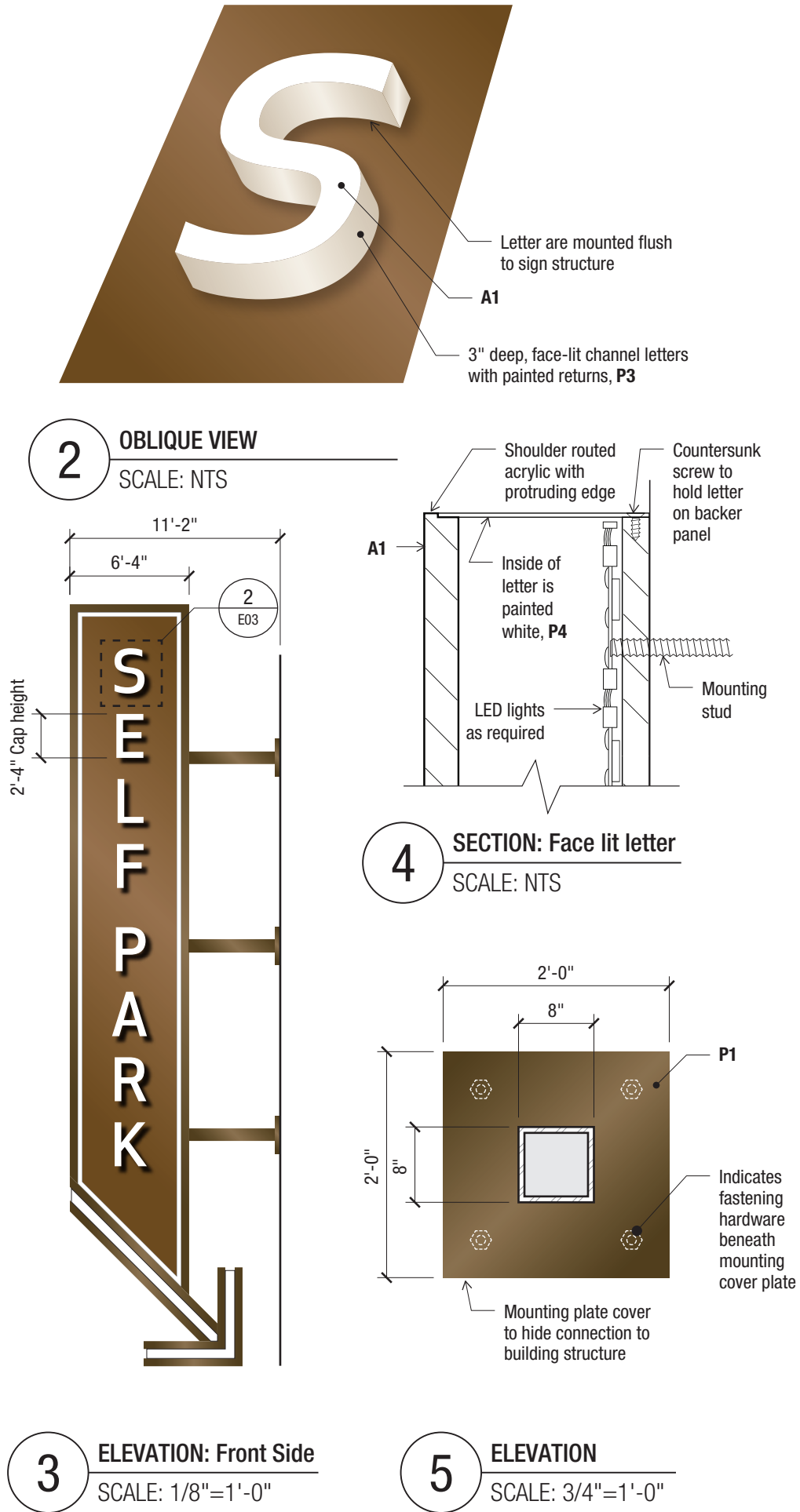

# KIKU OBATA

Kiku Obata & Company  
6161 Delmar Blvd., Suite 200  
St. Louis, MO 63112  
Office 314.361.3110  
Fax 314.361.4716  
www.kikuobata.com

Owner:  
Hard Rock International

Client:  
SOSH Architects  
1020 Atlantic Avenue  
Atlantic City, NJ 08401  
609-345-5222

Authorized Use:  
**Bid Set**

Issue Date: February 15, 2018

Revisions:				
No.	Date	Description	Drawn By	
1	-	-		
2	-	-		
3	-	-		
4	-	-		
5	-	-		
6	-	-		
7	-	-		
8	-	-		
9	-	-		
10	-	-		

All reproduction and intellectual  
property rights reserved.  
© 2018 Kiku Obata & Company

**Hard Rock Hotel & Casino  
Atlantic City**  
1000 Boardwalk  
Atlantic City, NJ 08401

Project Number: 2017024.00

Sign Quantity: **01**

**Type BB  
Self Park Blade**

Drawn by: JR/LM **SG-20-3-E03**  
Checked by: LM/KO

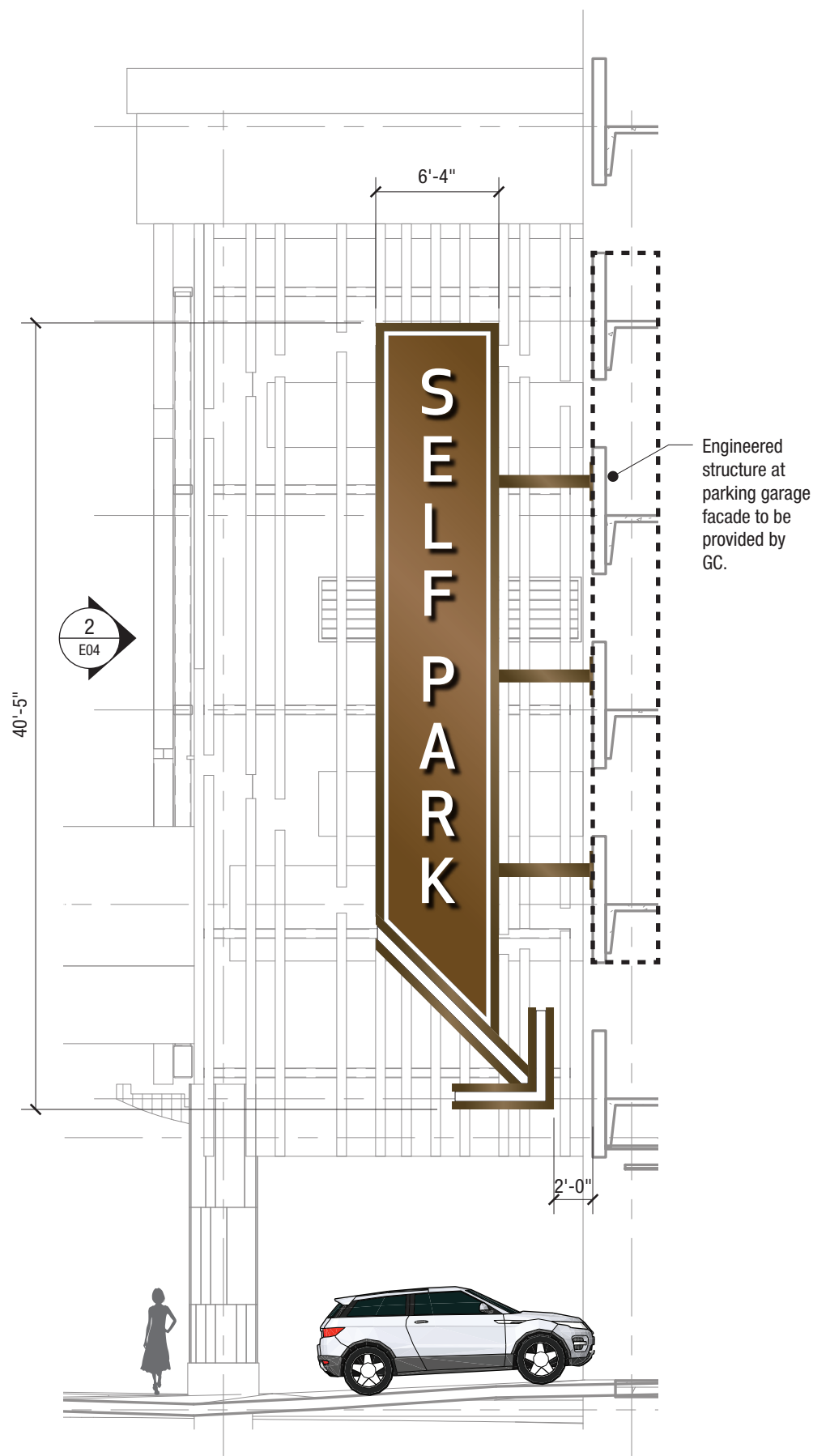

1 ELEVATION  
SCALE: 1/8"=1'-0"

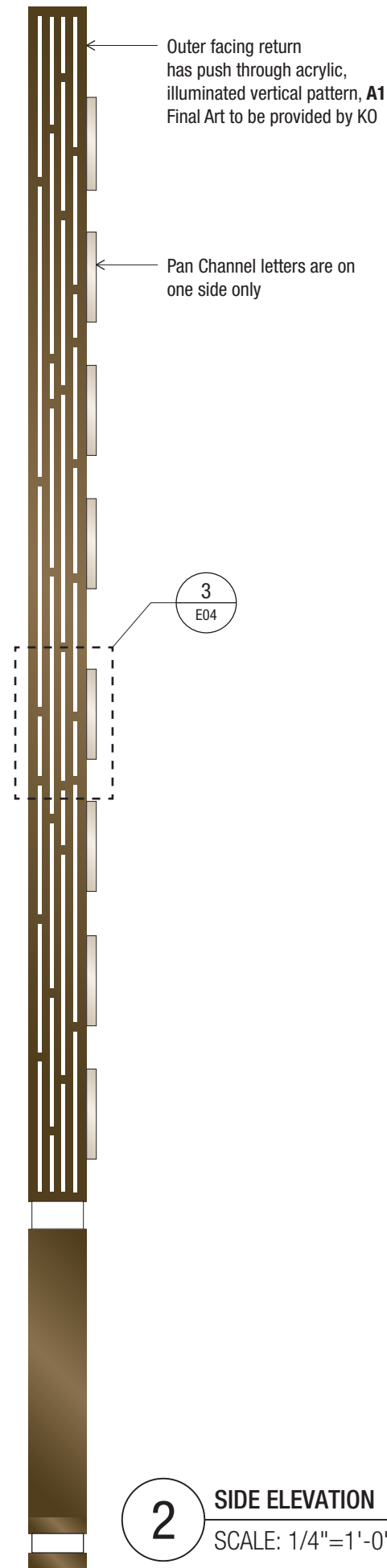

2 SIDE ELEVATION  
SCALE: 1/4"=1'-0"

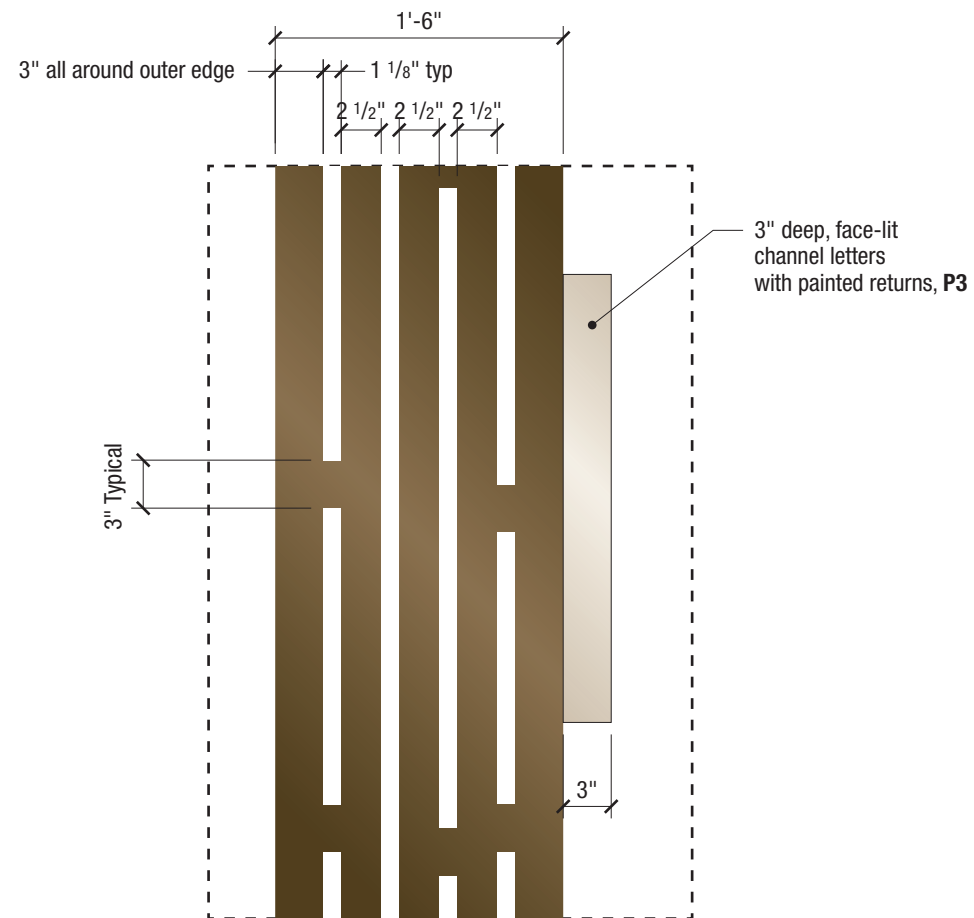

3 ELEVATION - Return Detail  
SCALE: 1"=1'-0"

### Push Through Acrylic

All push-through acrylic shall be cut true to the letter, glyph and symbol forms - rounded corners will not be acceptable. Push-through acrylic shall be proud of the sign panel face by no less than 1/8" and no more than 1/4"

### General Notes:

- Electric to be pulled to location by others.  
Sign Contractor is responsible for electrical hook up.
- All lighting to be internal LED with no light leaks.  
Vents shall be shielded to prevent light leak.
- Internal lighting to be even across all illuminated features with no hot or cool spots.
- Lighting color temperature to be \_\_\_\_K
- Engineered structure at parking garage facade to be provided by GC.  
Sign Contractor to coordinate with GC on structural requirements.
- All fasteners to be hidden from view.

# KIKU OBATA

Kiku Obata & Company  
6161 Delmar Blvd., Suite 200  
St. Louis, MO 63112  
Office 314.361.3110  
Fax 314.361.4716  
www.kikuobata.com

Owner:  
Hard Rock International

Client:  
SOSH Architects  
1020 Atlantic Avenue  
Atlantic City, NJ 08401  
609-345-5222

Authorized Use:  
**Bid Set**

Issue Date: February 15, 2018

Revisions:				
No.	Date	Description	Drawn By	
1	-	-		
2	-	-		
3	-	-		
4	-	-		
5	-	-		
6	-	-		
7	-	-		
8	-	-		
9	-	-		
10	-	-		

All reproduction and intellectual  
property rights reserved.  
© 2018 Kiku Obata & Company

**Hard Rock Hotel & Casino  
Atlantic City**  
1000 Boardwalk  
Atlantic City, NJ 08401

Project Number: 2017024.00

Sign Quantity: 01

**Type BB  
Self Park Blade**

Drawn by: JR/LM **SG-20-3-E04**  
Checked by: LM/KO



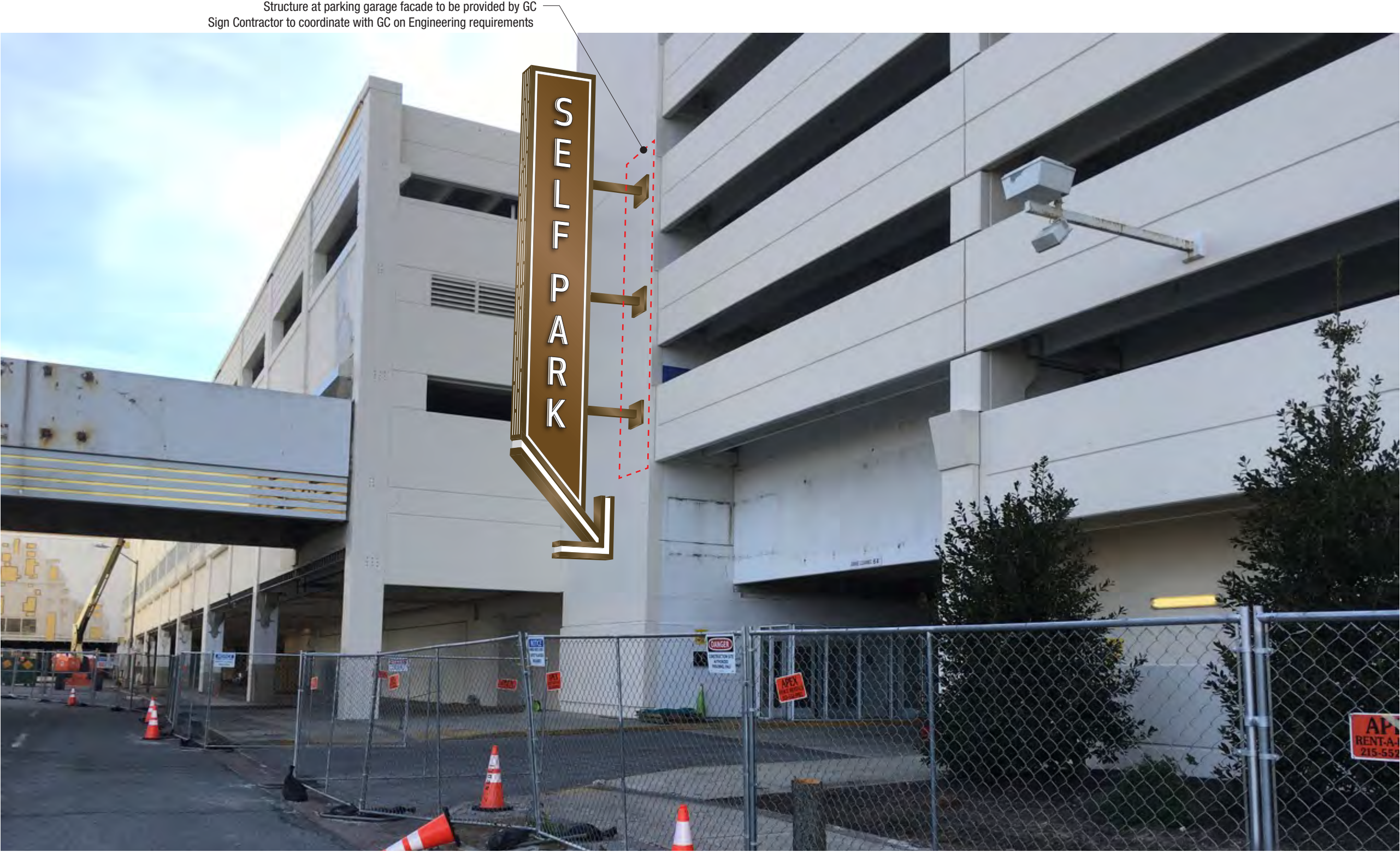

1 PHOTO: Location  
SCALE: NTS

# KIKU OBATA

Kiku Obata & Company  
6161 Delmar Blvd., Suite 200  
St. Louis, MO 63112  
Office 314.361.3110  
Fax 314.361.4716  
www.kikuobata.com

Owner:  
Hard Rock International

Client:  
SOSH Architects  
1020 Atlantic Avenue  
Atlantic City, NJ 08401  
609-345-5222

Authorized Use:  
**Bid Set**

Issue Date: February 15, 2018

Revisions:			
No.	Date	Description	Drawn By
1	-	-	
2	-	-	
3	-	-	
4	-	-	
5	-	-	
6	-	-	
7	-	-	
8	-	-	
9	-	-	
10	-	-	

All reproduction and intellectual  
property rights reserved.  
© 2018 Kiku Obata & Company

**Hard Rock Hotel & Casino**  
**Atlantic City**  
1000 Boardwalk  
Atlantic City, NJ 08401

Project Number: 2017024.00

Sign Quantity: **01**

**Type BB**  
**Self Park Blade**

Drawn by: JR/LM **SG-20-3-E05**  
Checked by: LM/KO



Revisions:			
No.	Date	Description	Drawn By
1	-	-	
2	-	-	
3	-	-	
4	-	-	
5	-	-	
6	-	-	
7	-	-	
8	-	-	
9	-	-	
10	-	-	

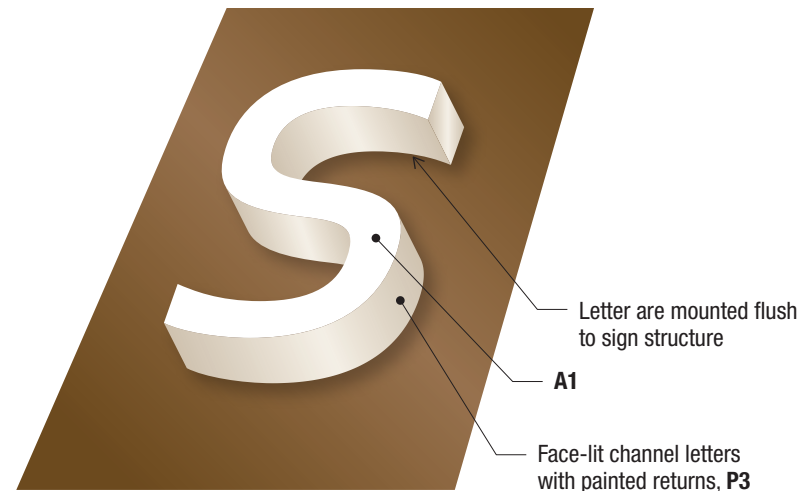

**1** OBLIQUE VIEW  
SCALE: NTS

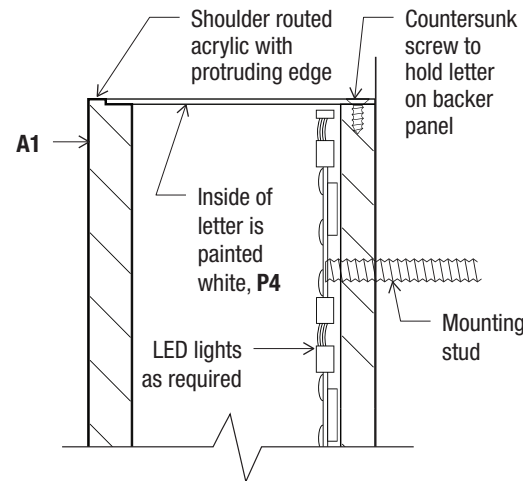

**2** SECTION: Face lit letter  
SCALE: NTS

**General Notes:**

- Electric to be pulled to locations by others.  
Sign Contractor is responsible for electrical hook up.
- All lighting to be internal LED with no light leaks.  
Vents shall be shielded to prevent light leak.
- Internal lighting to be even across all letter faces  
with no hot or cool spots.
- Lighting color temperature to be \_\_\_\_ K
- Sign Contractor to coordinate with GC on attachment  
to parking garage facade..
- All fasteners to be hidden from view.

Reverse metal pan panel applied to garage entry  
facade, **P2**  
All electrical to be concealed within pan sign panel.  
Seams shall be tight and called out on shop drawings.

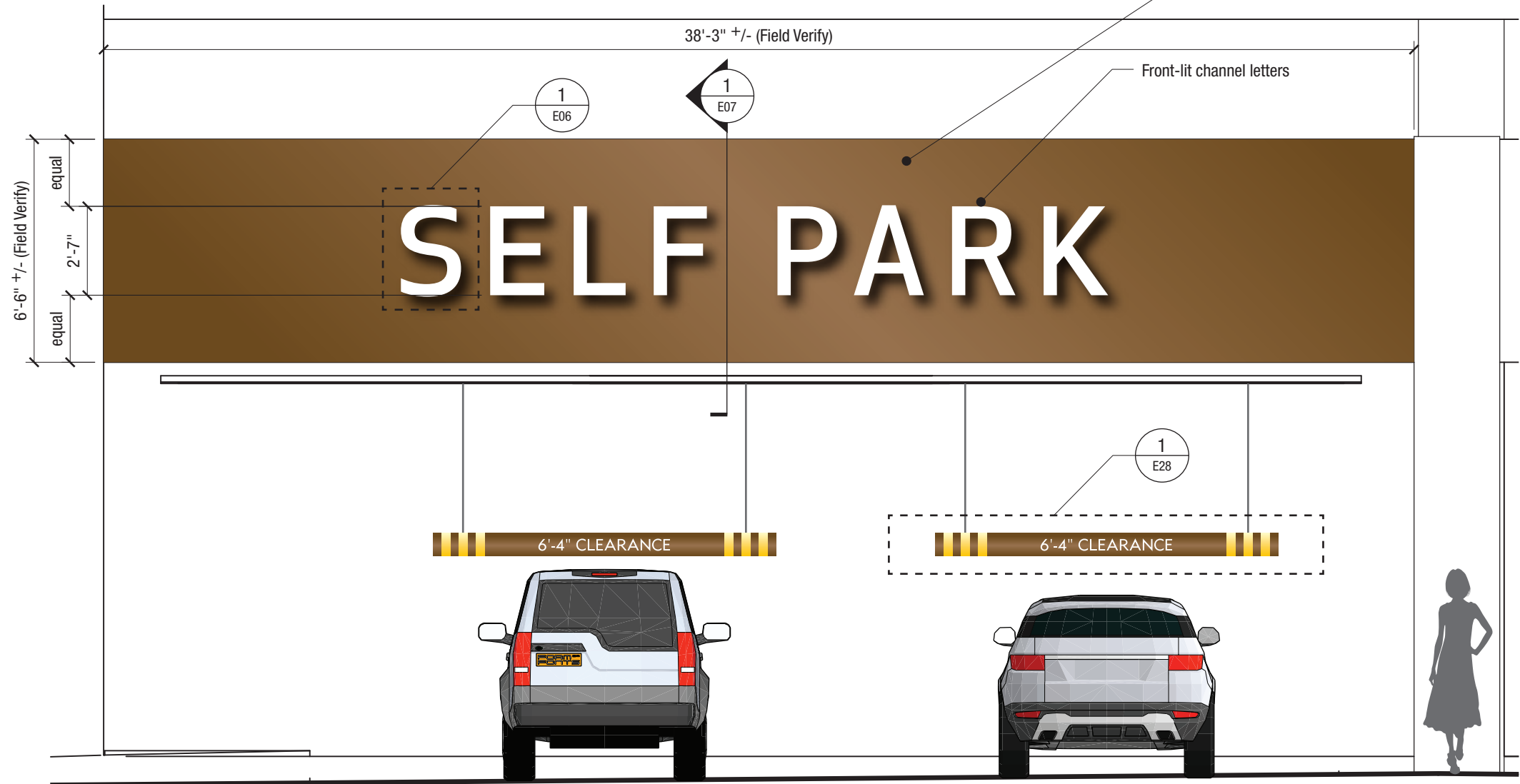

**3** ELEVATION  
SCALE: 1/4"=1'-0"

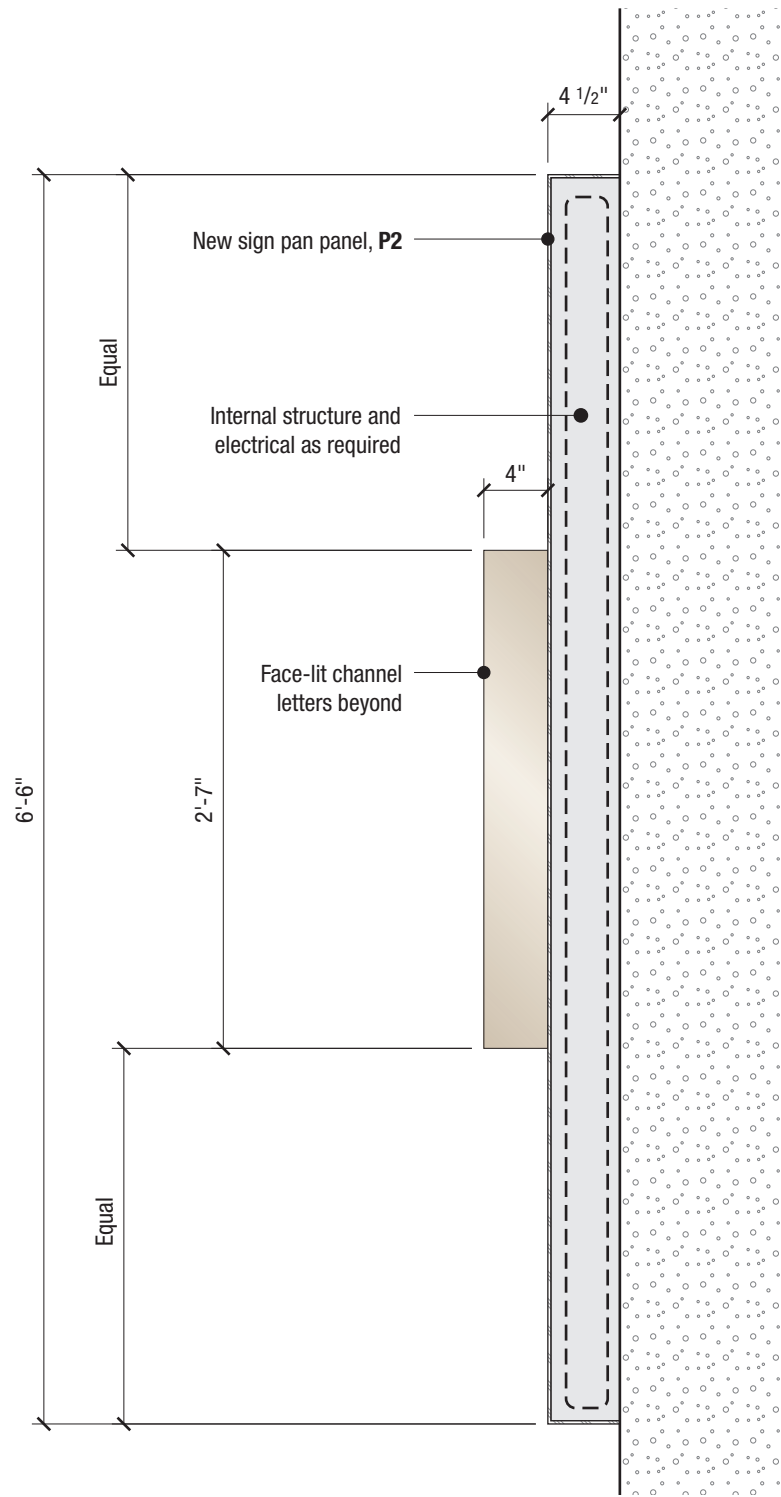

**1** SECTION  
SCALE: 1"=1'-0"



**2** PHOTO: Existing Condition  
SCALE: 3/4"=1'-0"



**3** PHOTO: Existing Condition  
SCALE: 3/4"=1'-0"

# KIKU OBATA

Kiku Obata & Company  
6161 Delmar Blvd., Suite 200  
St. Louis, MO 63112  
Office 314.361.3110  
Fax 314.361.4716  
www.kikuobata.com

Owner:  
Hard Rock International

Client:  
SOSH Architects  
1020 Atlantic Avenue  
Atlantic City, NJ 08401  
609-345-5222

Authorized Use:  
**Bid Set**

Issue Date: February 15, 2018

Revisions:			
No.	Date	Description	Drawn By
1	-	-	
2	-	-	
3	-	-	
4	-	-	
5	-	-	
6	-	-	
7	-	-	
8	-	-	
9	-	-	
10	-	-	

All reproduction and intellectual  
property rights reserved.  
© 2018 Kiku Obata & Company

**Hard Rock Hotel & Casino  
Atlantic City**  
1000 Boardwalk  
Atlantic City, NJ 08401

Project Number: 2017024.00

Sign Quantity: **01**

**Type CC1  
Self Park ID at Entrance**

Drawn by: JR/LM **SG-20-3-E07**  
Checked by: LM/KO



1 OBLIQUE VIEW  
SCALE: NTS

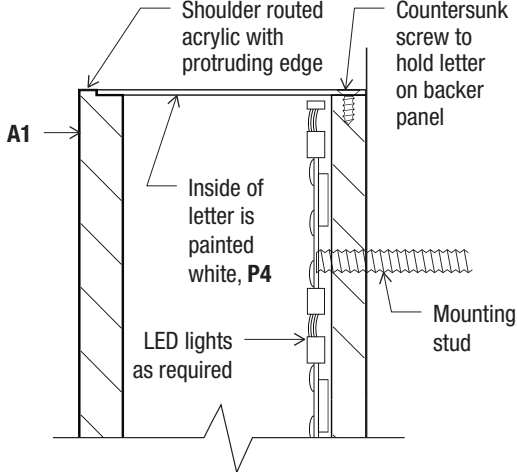

2 SECTION: Face lit letter  
SCALE: NTS

- General Notes:**
- Electric to be pulled to locations by others.  
Sign Contractor is responsible for electrical hook up.
  - All lighting to be internal LED with no light leaks.  
Vents shall be shielded to prevent light leak.
  - Internal lighting to be even across all letter faces with no hot or cool spots.
  - Lighting color temperature to be \_\_\_\_K
  - Sign Contractor to coordinate with GC on attachment to building facade..
  - All fasteners to be hidden from view.

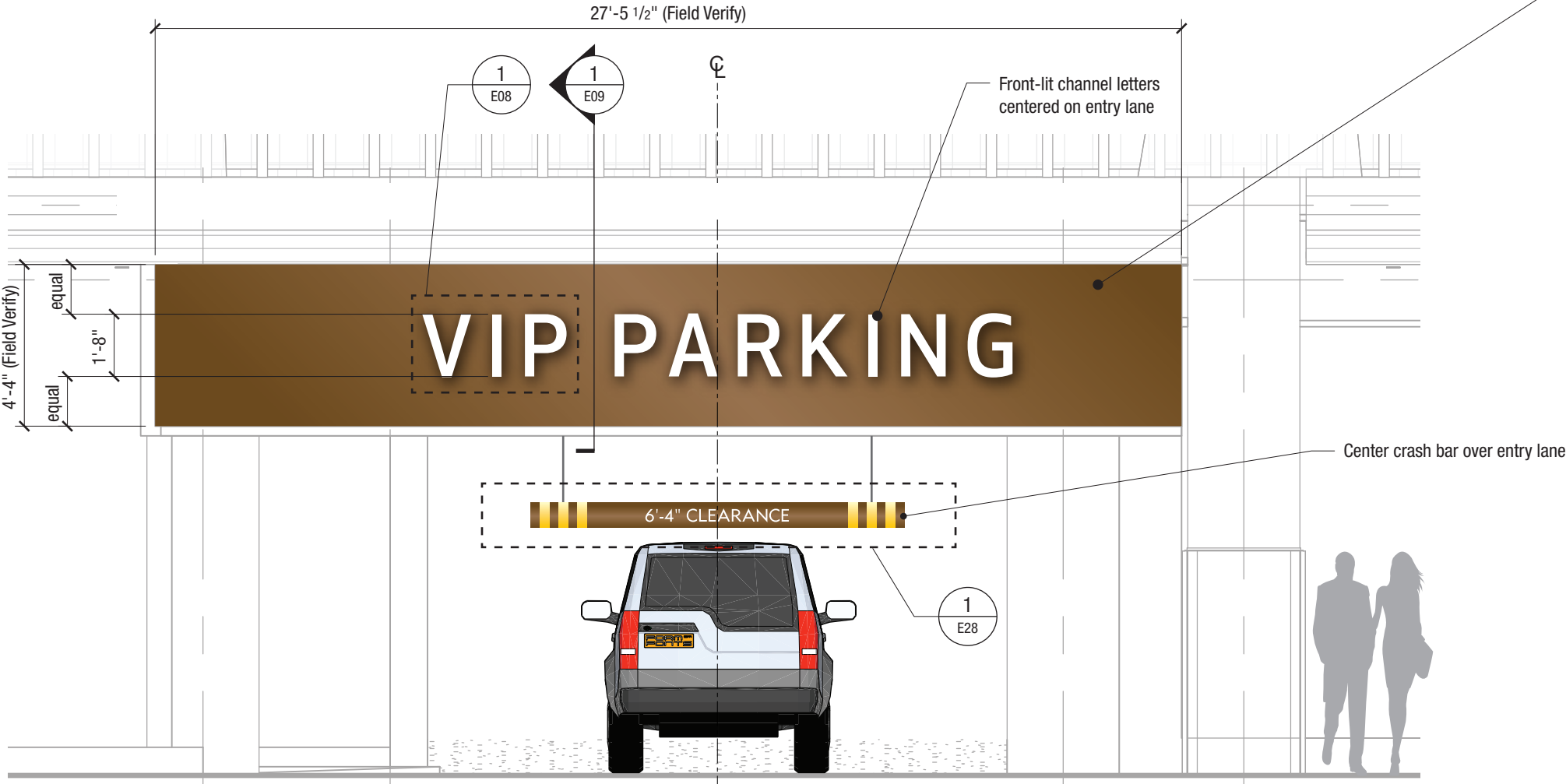

3 SECTION  
SCALE: 1/4"=1'-0"

# KIKU OBATA

Kiku Obata & Company  
6161 Delmar Blvd., Suite 200  
St. Louis, MO 63112  
Office 314.361.3110  
Fax 314.361.4716  
www.kikuobata.com

Owner:  
Hard Rock International

Client:  
SOSH Architects  
1020 Atlantic Avenue  
Atlantic City, NJ 08401  
609-345-5222

Authorized Use:  
**Bid Set**

Issue Date: February 15, 2018

Revisions:			
No.	Date	Description	Drawn By
1	-	-	
2	-	-	
3	-	-	
4	-	-	
5	-	-	
6	-	-	
7	-	-	
8	-	-	
9	-	-	
10	-	-	

All reproduction and intellectual  
property rights reserved.  
© 2018 Kiku Obata & Company

**Hard Rock Hotel & Casino  
Atlantic City**  
1000 Boardwalk  
Atlantic City, NJ 08401

Project Number: 2017024.00

Sign Quantity: 01

**Type CC2  
VIP Parking ID at Entrance**

Drawn by: JR/LM **SG-20-3-E08**  
Checked by: LM/KO



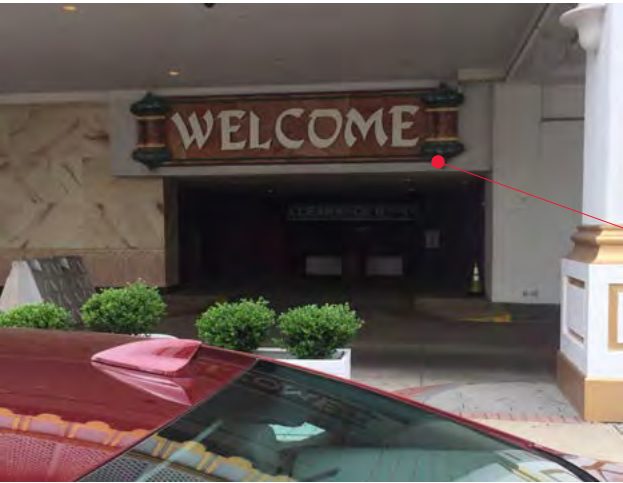

Existing sign has been removed

2 PHOTO: Existing Condition  
SCALE: 3/4"=1'-0"

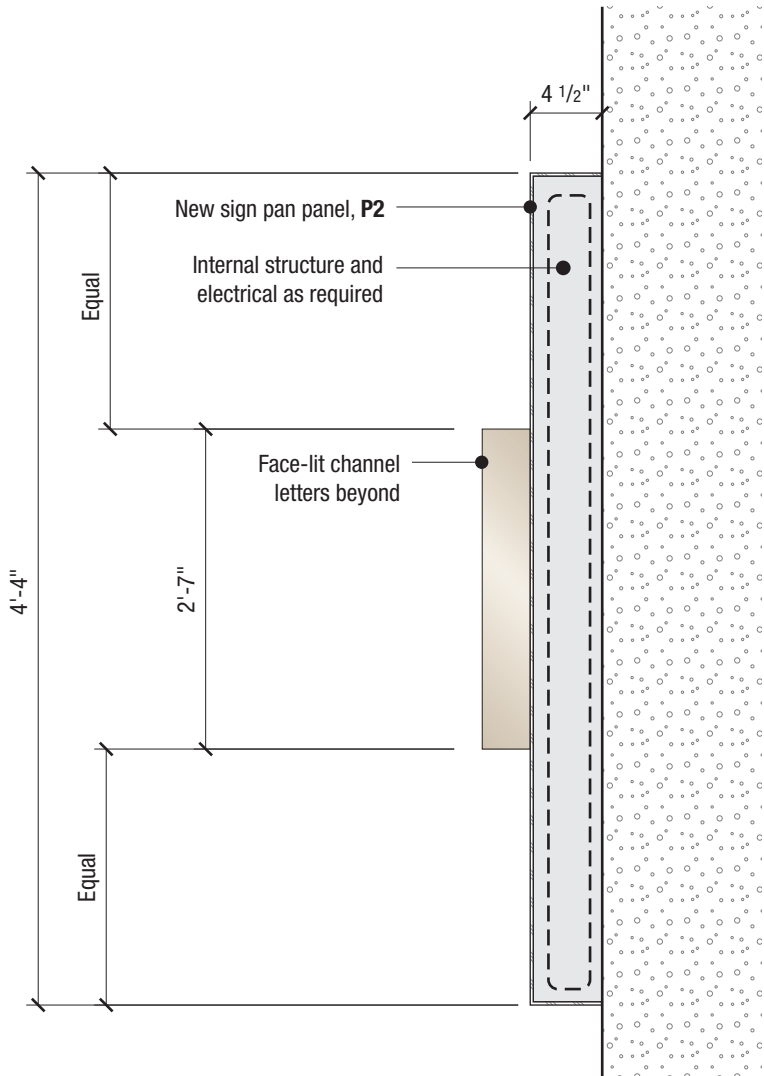

1 SECTION  
SCALE: 1"=1'-0"



Placement of new Entry ID sign

3 PHOTO: Existing Condition  
SCALE: 3/4"=1'-0"

# KIKU OBATA

Kiku Obata & Company  
6161 Delmar Blvd., Suite 200  
St. Louis, MO 63112  
Office 314.361.3110  
Fax 314.361.4716  
www.kikuobata.com

Owner:  
Hard Rock International

Client:  
SOSH Architects  
1020 Atlantic Avenue  
Atlantic City, NJ 08401  
609-345-5222

Authorized Use:  
**Bid Set**

Issue Date: February 15, 2018

Revisions:			
No.	Date	Description	Drawn By
1	-	-	
2	-	-	
3	-	-	
4	-	-	
5	-	-	
6	-	-	
7	-	-	
8	-	-	
9	-	-	
10	-	-	

All reproduction and intellectual  
property rights reserved.  
© 2018 Kiku Obata & Company

**Hard Rock Hotel & Casino  
Atlantic City**  
1000 Boardwalk  
Atlantic City, NJ 08401

Project Number: 2017024.00

Sign Quantity: 01

**Type CC2  
VIP Parking ID at Entrance**

Drawn by: JR/LM **SG-20-3-E09**  
Checked by: LM/KO

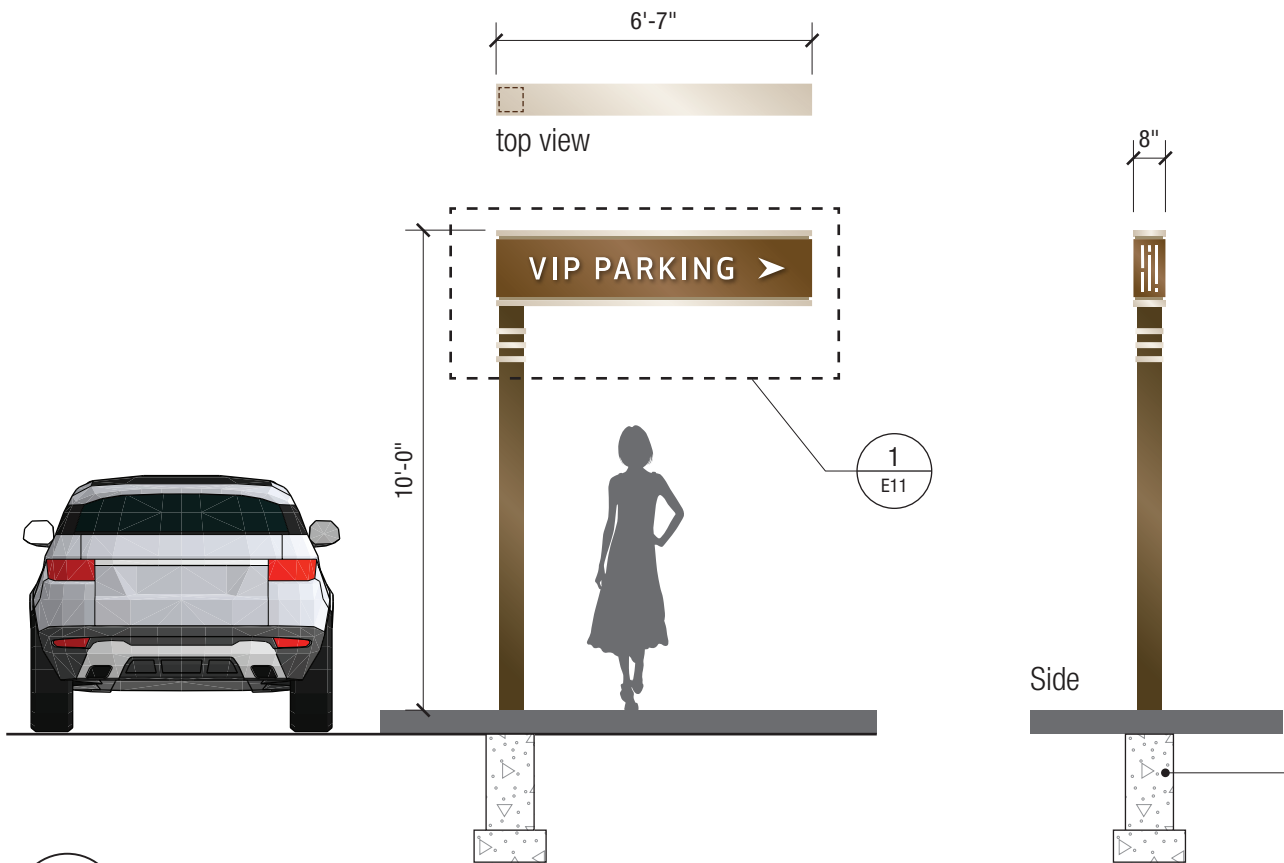

**1** ELEVATION  
SCALE: 1/4"=1'-0"

**General Notes:**

- Electric to be pulled to locations by others. Sign Contractor is responsible for electrical hook up.
- All lighting to be internal LED with no light leaks. Vents shall be shielded to prevent light leak.
- Internal lighting to be even across all messages with no hot or cool spots.
- Lighting color temperature to be \_\_\_\_ K
- All footings to be provided by GC. Sign Contractor to coordinate with GC on structural requirements.
- Field verify all locations for proper power and footings.

**Push Through Acrylic**

All push-through acrylic shall be cut true to the letter, glyph and symbol forms - rounded corners will not be acceptable. Push-through acrylic shall be proud of the sign panel face by no less than 1/8" and no more than 1/4"

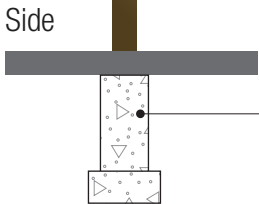
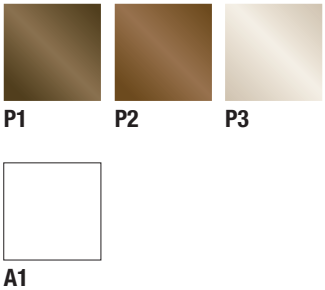

Sign Contractor's structural engineer to submit signed and sealed engineered drawings of footings and sign structures. Allow for power to come up through footing and into the interior of the sign cabinet.

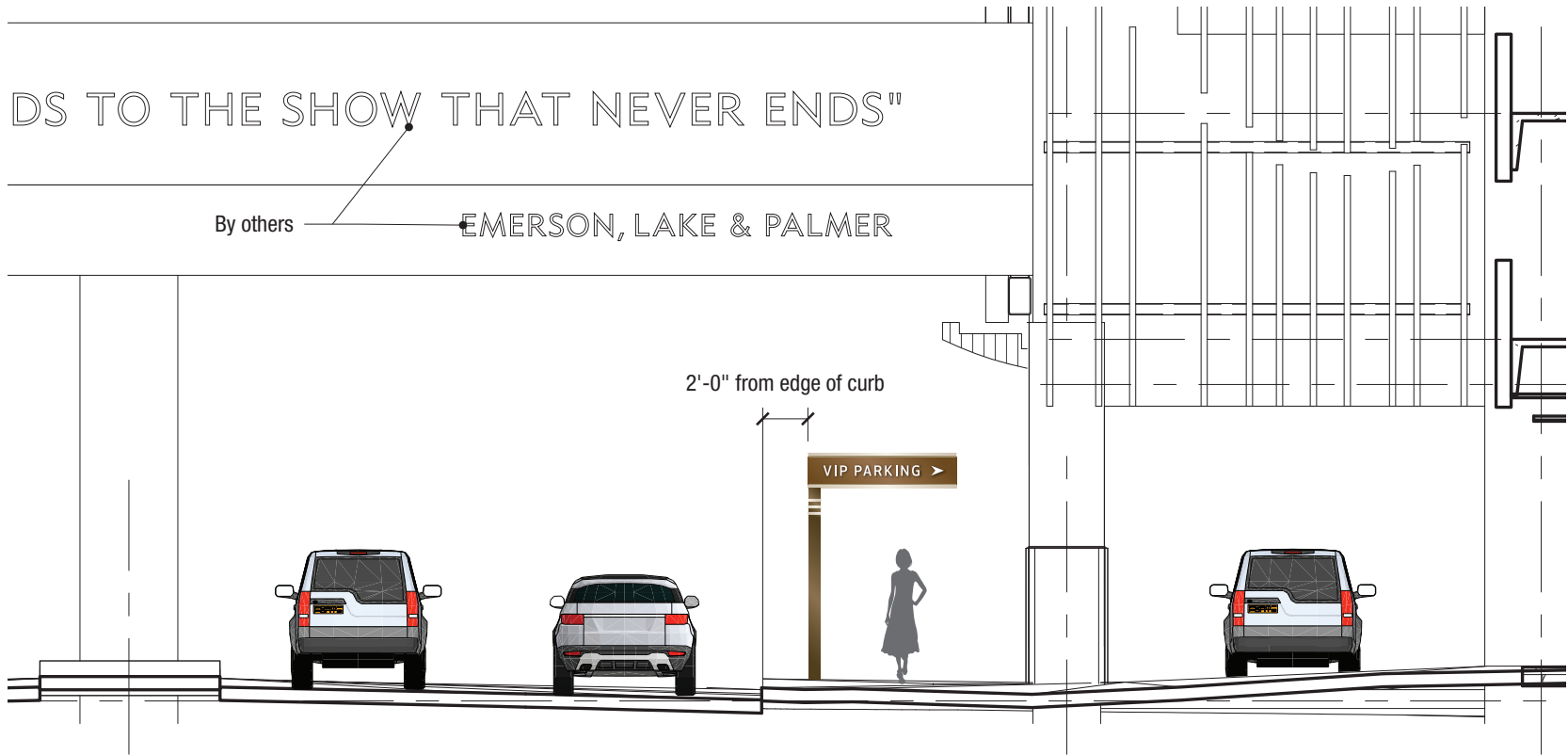

**2** ELEVATION  
SCALE: 1/8"=1'-0"

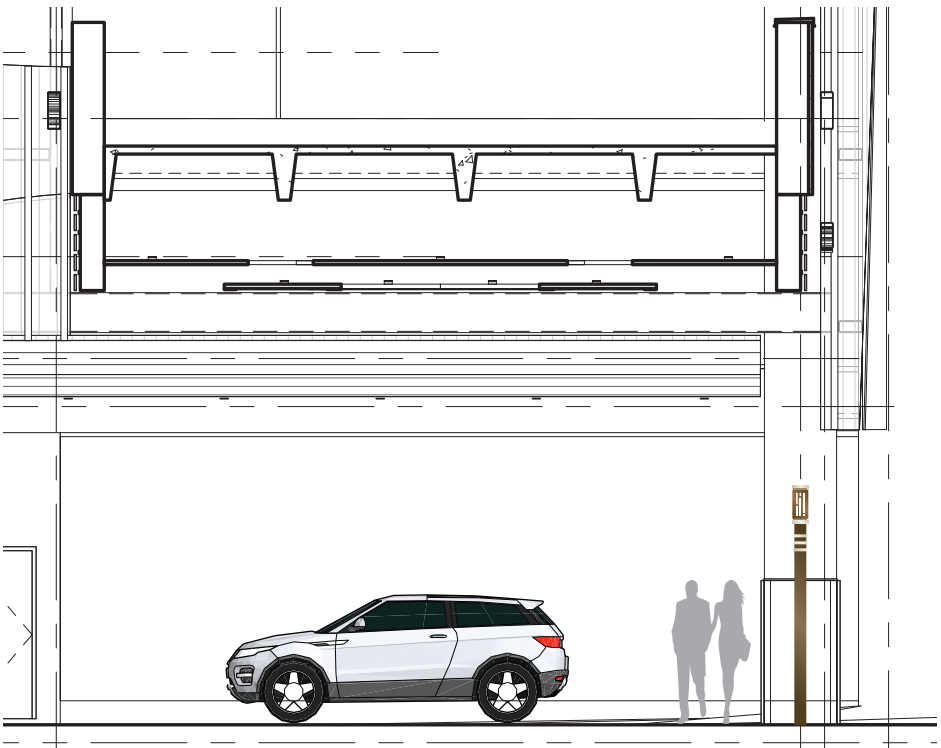

**3** ELEVATION  
SCALE: 1/8"=1'-0"

# KIKU OBATA

Kiku Obata & Company  
6161 Delmar Blvd., Suite 200  
St. Louis, MO 63112  
Office 314.361.3110  
Fax 314.361.4716  
www.kikuobata.com

Owner:  
Hard Rock International

Client:  
SOSH Architects  
1020 Atlantic Avenue  
Atlantic City, NJ 08401  
609-345-5222

Authorized Use:  
**Bid Set**

Issue Date: February 15, 2018

Revisions:			
No.	Date	Description	Drawn By
1	-	-	
2	-	-	
3	-	-	
4	-	-	
5	-	-	
6	-	-	
7	-	-	
8	-	-	
9	-	-	
10	-	-	

All reproduction and intellectual property rights reserved.  
© 2018 Kiku Obata & Company

**Hard Rock Hotel & Casino  
Atlantic City**  
1000 Boardwalk  
Atlantic City, NJ 08401

Project Number: 2017024.00

Sign Quantity: **01**

**Sign Type DD  
VIP Parking Directional**

Drawn by: JR/LM **SG-20-3-E10**  
Checked by: LM/KO

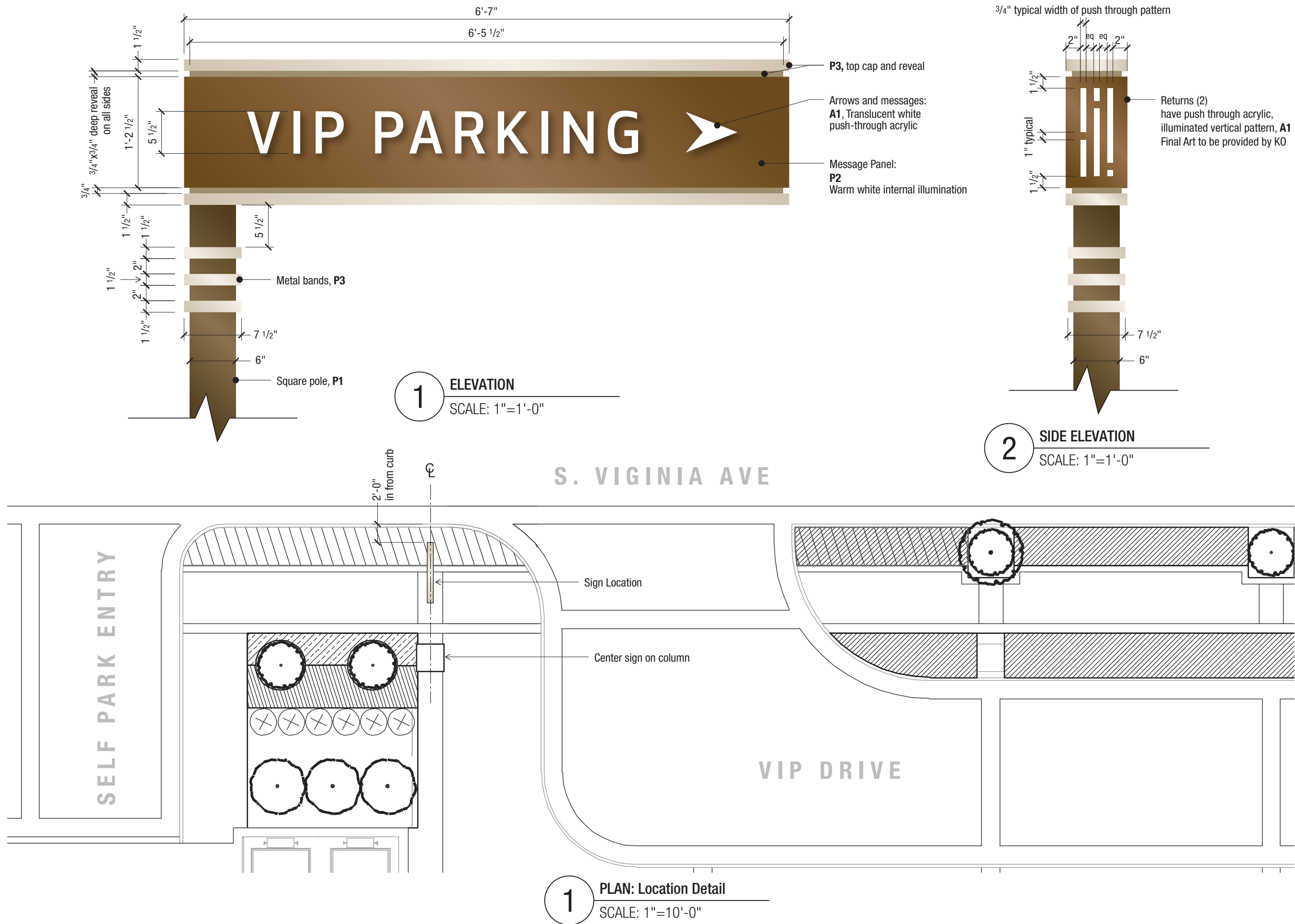

KIKU OBATA

Kiku Obata & Company  
6161 Delmar Blvd., Suite 200  
St. Louis, MO 63112  
Office 314.361.3110  
Fax 314.361.4716  
www.kikuobata.com

Owner:  
Hard Rock International

Client:  
SOSH Architects  
1020 Atlantic Avenue  
Atlantic City, NJ 08401  
609-345-5222

Authorized Use:  
Bid Set

Issue Date: February 15, 2018

Revisions:				
No.	Date	Description	Drawn By	
1	-	-		
2	-	-		
3	-	-		
4	-	-		
5	-	-		
6	-	-		
7	-	-		
8	-	-		
9	-	-		
10	-	-		

All reproduction and intellectual  
property rights reserved.  
© 2018 Kiku Obata & Company

Hard Rock Hotel & Casino  
Atlantic City  
1000 Boardwalk  
Atlantic City, NJ 08401

Project Number: 2017024.00

Sign Quantity: 01

Sign Type DD  
VIP Parking Directional

Drawn by: JR/LM  
Checked by: LM/KO  
SG-20-3-E11



**General Notes:**

- Electric to be pulled to locations by others. Sign Contractor is responsible for electrical hook up.
- All lighting to be internal LED with no light leaks. Vents shall be shielded to prevent light leak.
- Internal lighting to be even across all messages with no hot or cool spots.
- Lighting color temperature to be \_\_\_\_K
- All fasteners to be hidden from view.

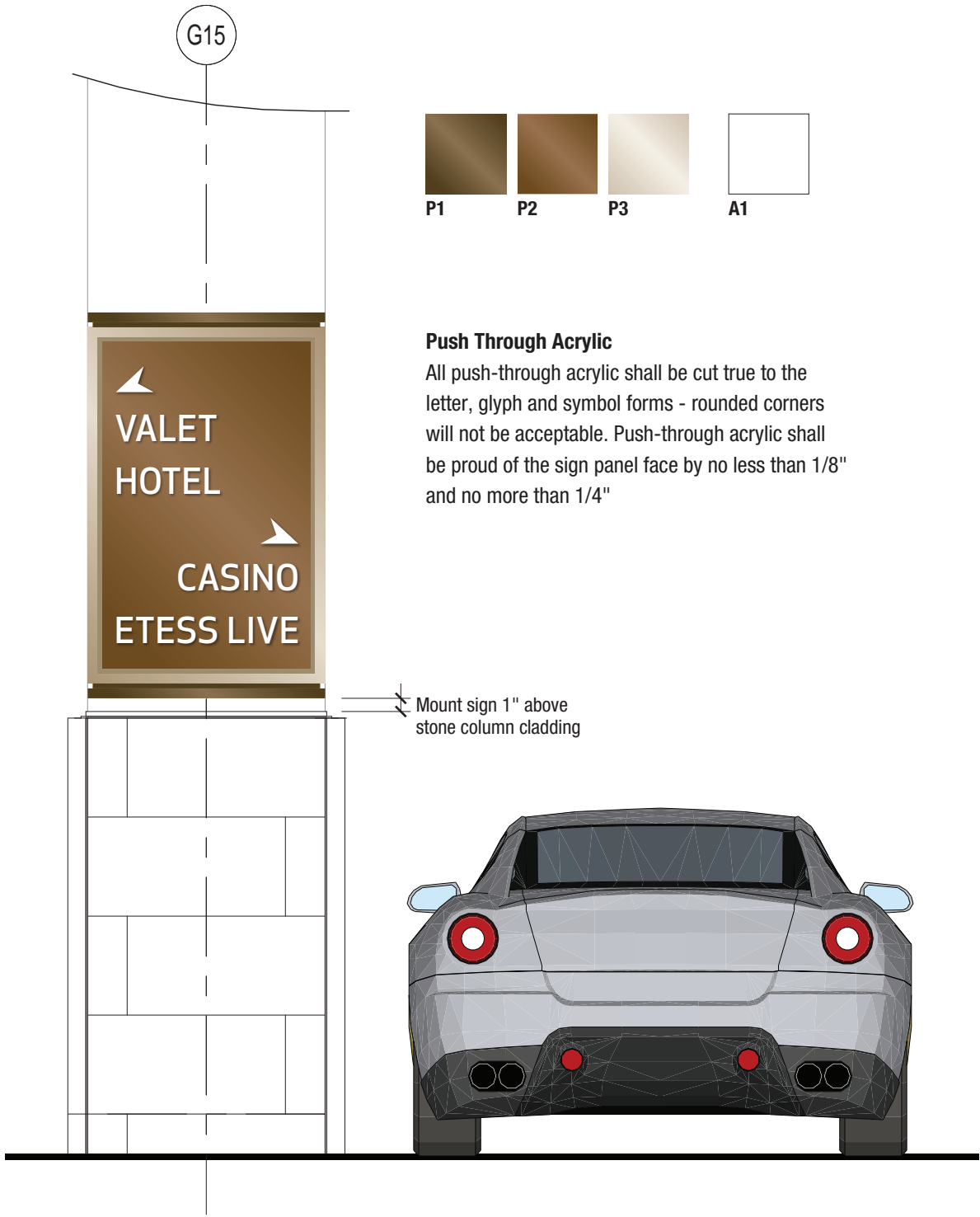

1

ELEVATION

SCALE: 1/2"=1'-0"

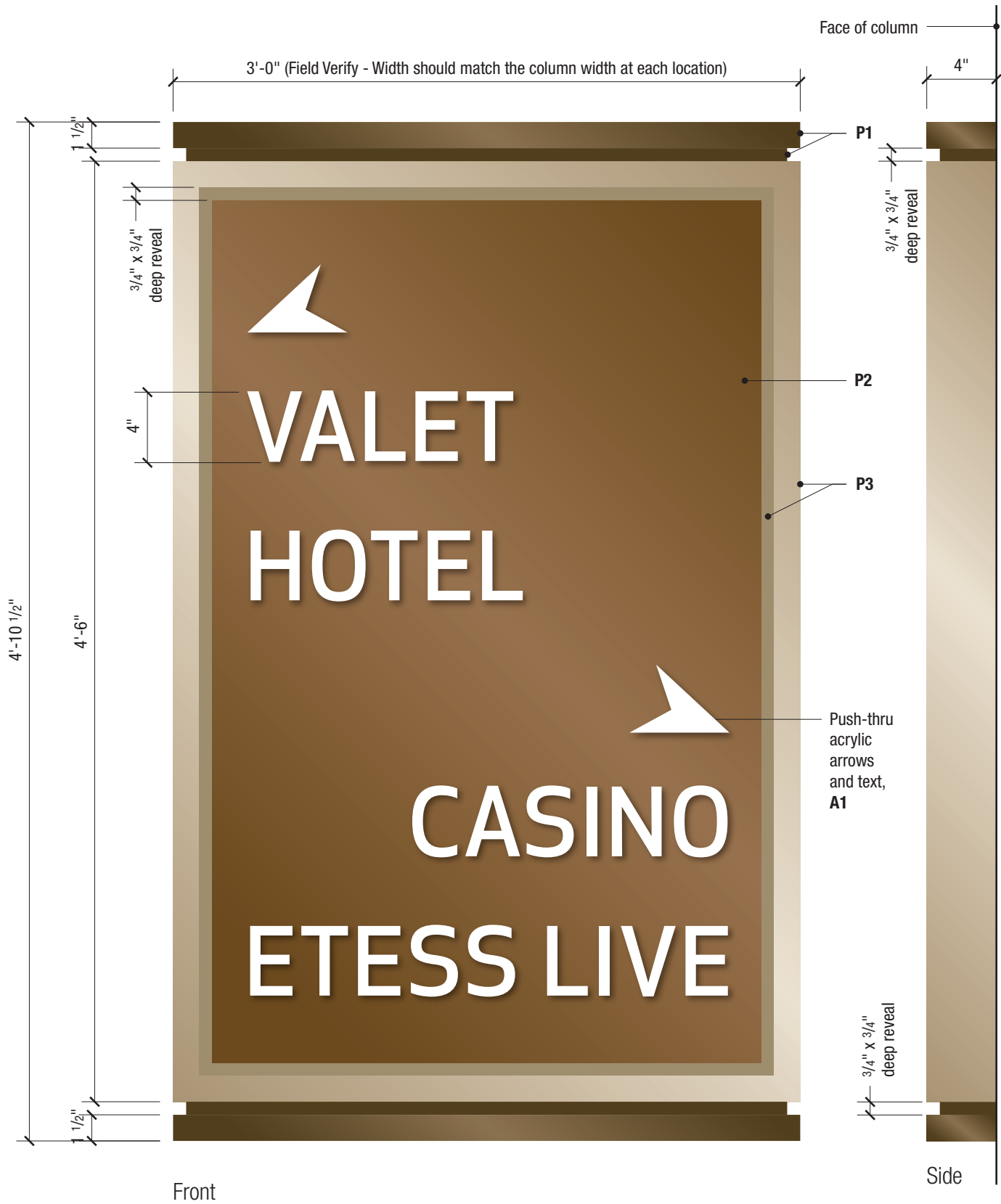

2

ELEVATION

SCALE: 1 1/2"=1'-0"

**KIKU OBATA**

Kiku Obata & Company  
6161 Delmar Blvd., Suite 200  
St. Louis, MO 63112  
Office 314.361.3110  
Fax 314.361.4716  
www.kikuobata.com

Owner:  
Hard Rock International

Client:  
SOSH Architects  
1020 Atlantic Avenue  
Atlantic City, NJ 08401  
609-345-5222

Authorized Use:  
**Bid Set**

Issue Date: February 15, 2018

Revisions:				
No.	Date	Description	Drawn By	
1	-	-		
2	-	-		
3	-	-		
4	-	-		
5	-	-		
6	-	-		
7	-	-		
8	-	-		
9	-	-		
10	-	-		

All reproduction and intellectual  
property rights reserved.  
© 2018 Kiku Obata & Company

**Hard Rock Hotel & Casino  
Atlantic City**  
1000 Boardwalk  
Atlantic City, NJ 08401

Project Number: 2017024.00

Sign Quantity: **04**

**Type EE  
Vehicle Directional - Column**

Drawn by: JR/LM **SG-20-3-E12**  
Checked by: LM/KO

\* All messages to be confirmed and approved by Owner

\* Artwork for all messages to be provided by KO

KIKU OBATA

Kiku Obata & Company  
6161 Delmar Blvd., Suite 200  
St. Louis, MO 63112  
Office 314.361.3110  
Fax 314.361.4716  
www.kikuobata.com

Owner:  
Hard Rock International

Client:  
SOSH Architects  
1020 Atlantic Avenue  
Atlantic City, NJ 08401  
609-345-5222

Authorized Use:  
Bid Set

Issue Date: February 15, 2018

Revisions:			
No.	Date	Description	Drawn By
1	-	-	
2	-		
3	-		
4	-	-	
5	-		
6	-	-	
7	-		
8	-		
9	-	-	
10	-		

All reproduction and intellectual  
property rights reserved.  
© 2018 Kiku Obata & Company

Hard Rock Hotel & Casino  
Atlantic City  
1000 Boardwalk  
Atlantic City, NJ 08401

Project Number: 2017024.00

Sign Quantity: 04

Type EE - Vehicle Directional  
Column - Messages

Drawn by: JR/LM      **SG-20-3-E13**  
Checked by: LM/KO



Location EE-15



Location EE-19



Location EE-20



Location EE-21

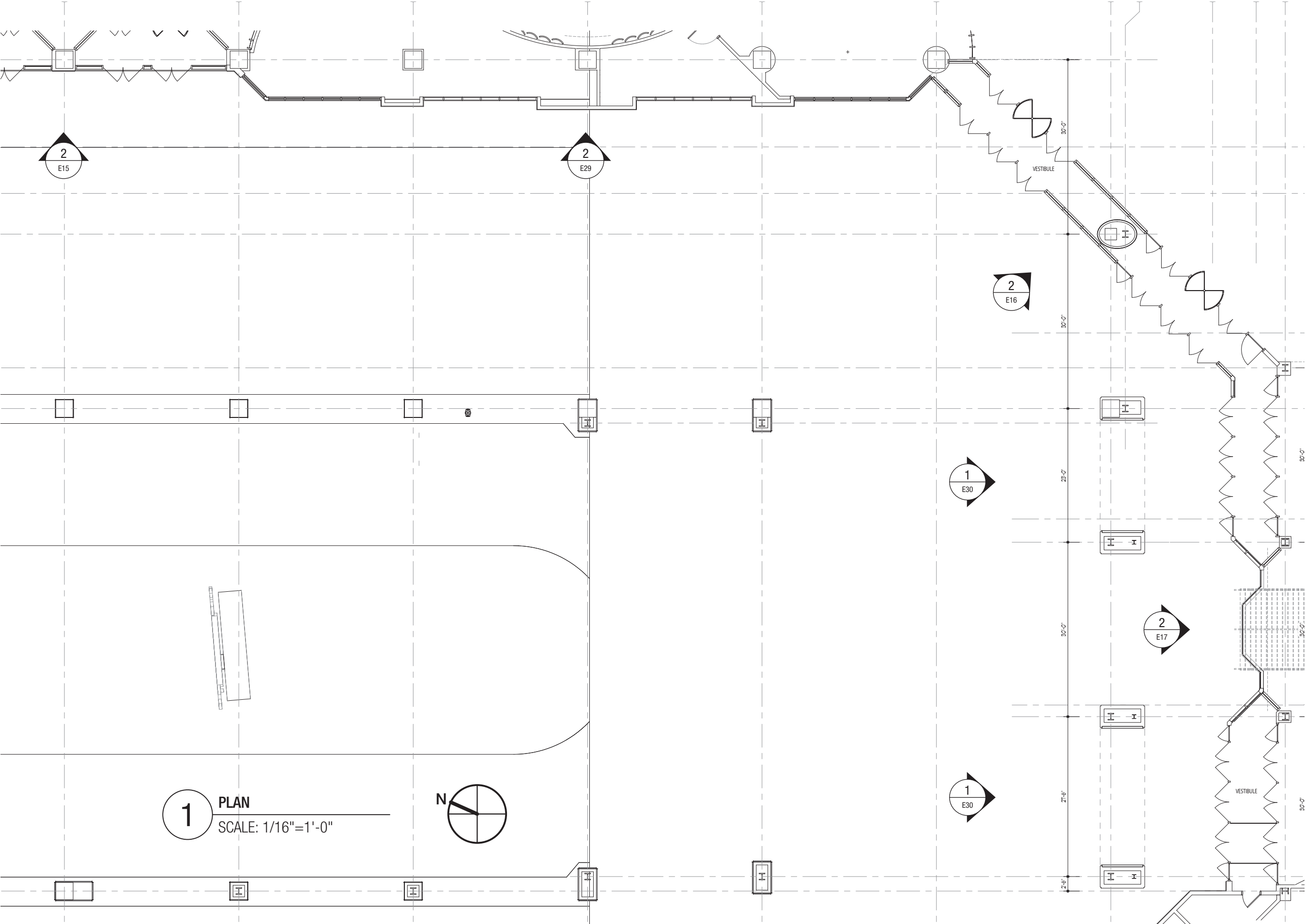

# KIKU OBATA

Kiku Obata & Company  
6161 Delmar Blvd., Suite 200  
St. Louis, MO 63112  
Office 314.361.3110  
Fax 314.361.4716  
www.kikuobata.com

Owner:  
Hard Rock International

Client:  
SOSH Architects  
1020 Atlantic Avenue  
Atlantic City, NJ 08401  
609-345-5222

Authorized Use:  
**Bid Set**

Issue Date: February 15, 2018

Revisions:			
No.	Date	Description	Drawn By
1	-	-	
2	-	-	
3	-	-	
4	-	-	
5	-	-	
6	-	-	
7	-	-	
8	-	-	
9	-	-	
10	-	-	

All reproduction and intellectual  
property rights reserved.  
© 2018 Kiku Obata & Company

**Hard Rock Hotel & Casino  
Atlantic City**  
1000 Boardwalk  
Atlantic City, NJ 08401

Project Number: 2017024.00

Sign Quantity: **00**

**Building Entry Plan  
Sign - Reference Views**

Drawn by: JR/LM **SG-20-3-E14**  
Checked by: LM/KO



# KIKU OBATA

Kiku Obata & Company  
6161 Delmar Blvd., Suite 200  
St. Louis, MO 63112  
Office 314.361.3110  
Fax 314.361.4716  
www.kikuobata.com

Owner:  
Hard Rock International

Client:  
SOSH Architects  
1020 Atlantic Avenue  
Atlantic City, NJ 08401  
609-345-5222

Authorized Use:  
**Bid Set**

Issue Date: February 15, 2018

Revisions:			
No.	Date	Description	Drawn By
1	-	-	
2	-	-	
3	-	-	
4	-	-	
5	-	-	
6	-	-	
7	-	-	
8	-	-	
9	-	-	
10	-	-	

All reproduction and intellectual  
property rights reserved.  
© 2018 Kiku Obata & Company

**Hard Rock Hotel & Casino**  
**Atlantic City**  
1000 Boardwalk  
Atlantic City, NJ 08401

Project Number: 2017024.00

Sign Quantity: **06**

**Type FF**  
**Building Entry ID**

Drawn by: JR/LM **SG-20-3-E15**  
Checked by: LM/KO

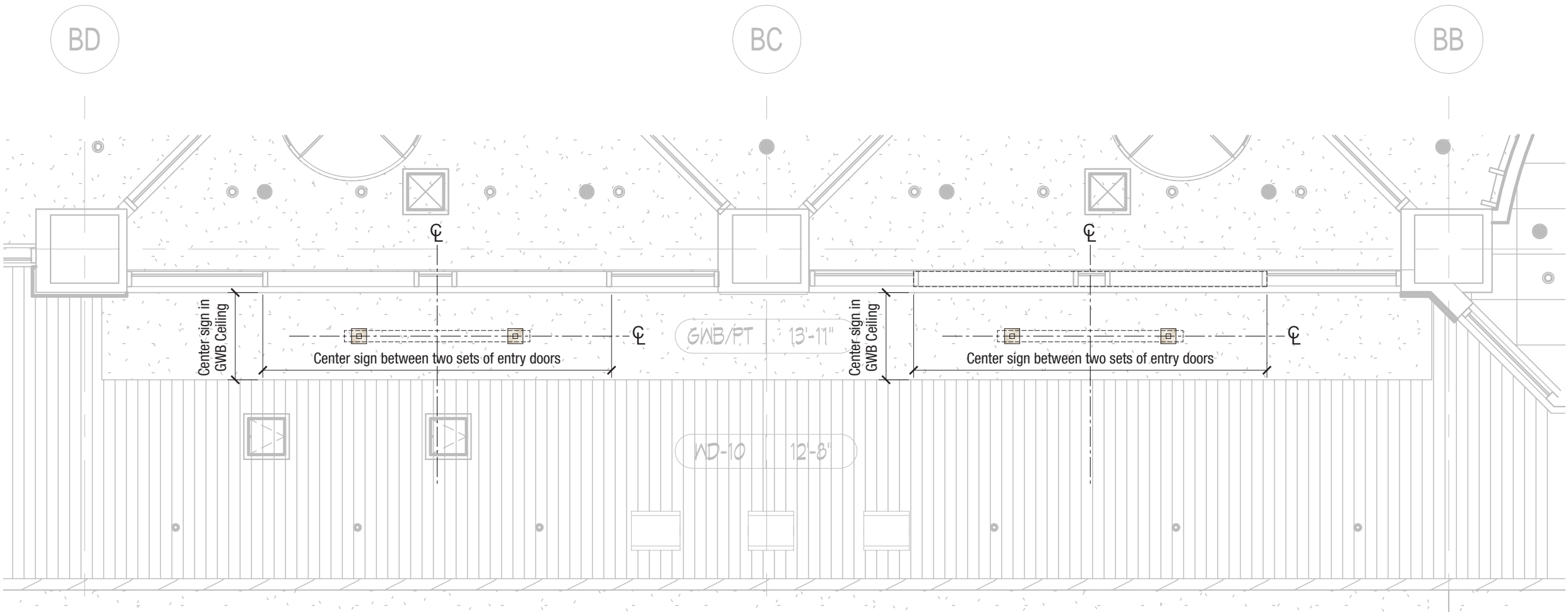

**1** RCP: Hotel Entry 1  
SCALE: 3/16"=1'-0"



**2**  
E18

**2**  
E18

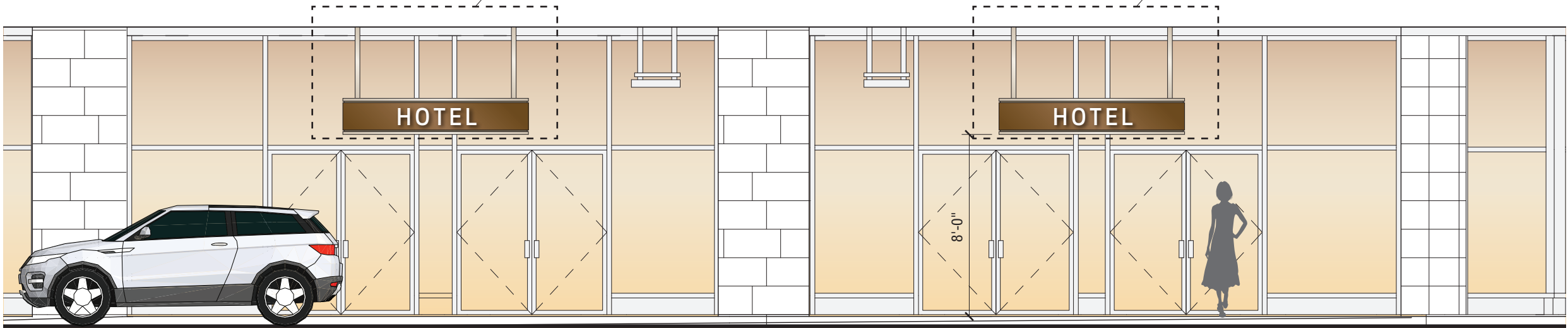

**2** ELEVATION: Hotel Entry 1  
SCALE: 3/16"=1'-0"

# KIKU OBATA

Kiku Obata & Company  
6161 Delmar Blvd., Suite 200  
St. Louis, MO 63112  
Office 314.361.3110  
Fax 314.361.4716  
www.kikuobata.com

Owner:  
Hard Rock International

Client:  
SOSH Architects  
1020 Atlantic Avenue  
Atlantic City, NJ 08401  
609-345-5222

Authorized Use:  
**Bid Set**

Issue Date: February 15, 2018

Revisions:			
No.	Date	Description	Drawn By
1	-	-	
2	-	-	
3	-	-	
4	-	-	
5	-	-	
6	-	-	
7	-	-	
8	-	-	
9	-	-	
10	-	-	

All reproduction and intellectual  
property rights reserved.  
© 2018 Kiku Obata & Company

**Hard Rock Hotel & Casino  
Atlantic City**  
1000 Boardwalk  
Atlantic City, NJ 08401

Project Number: 2017024.00

Sign Quantity: **06**

**Type FF  
Building Entry ID**

Drawn by: JR/LM **SG-20-3-E16**  
Checked by: LM/KO

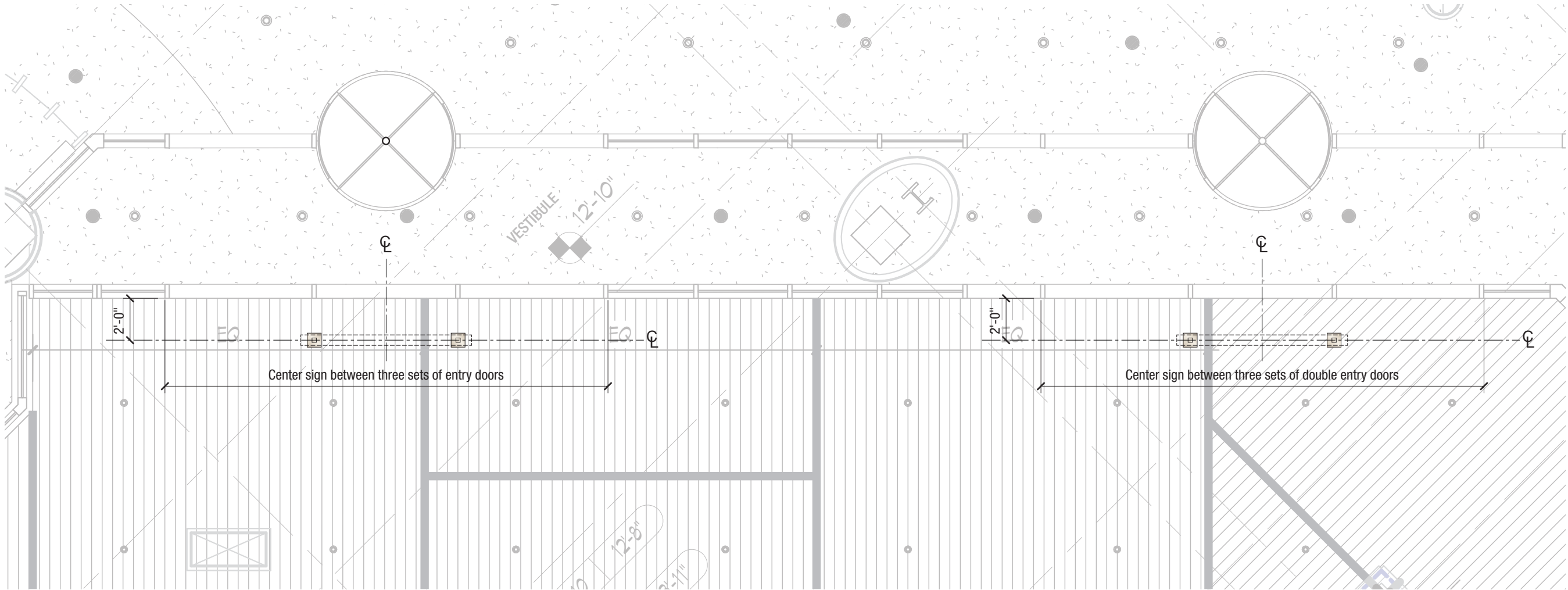

**1** RCP: Hotel Entry 2  
SCALE: 3/16"=1'-0"

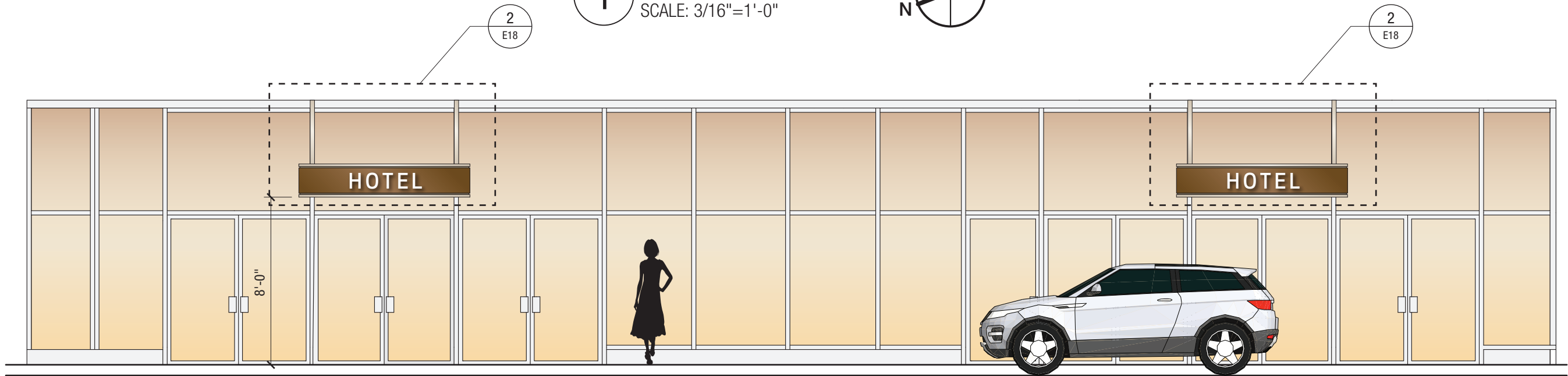

**2** ELEVATION: Hotel Entry 2  
SCALE: 3/16"=1'-0"

# KIKU OBATA

Kiku Obata & Company  
6161 Delmar Blvd., Suite 200  
St. Louis, MO 63112  
Office 314.361.3110  
Fax 314.361.4716  
www.kikuobata.com

**Owner:**  
Hard Rock International

**Client:**  
SOSH Architects  
1020 Atlantic Avenue  
Atlantic City, NJ 08401  
609-345-5222

Authorized Use:

**Bid Set**

Issue Date: February 15, 2018

Revisions:				
No.	Date	Description	Drawn By	
1	-	-		
2	-	-		
3	-	-		
4	-	-		
5	-	-		
6	-	-		
7	-	-		
8	-	-		
9	-	-		
10	-	-		

All reproduction and intellectual  
property rights reserved.  
© 2018 Kiku Obata & Company

**Hard Rock Hotel & Casino**  
**Atlantic City**  
1000 Boardwalk  
Atlantic City, NJ 08401

Project Number: 2017024.00

Sign Quantity: **06**

**Type FF**  
**Building Entry ID**

Drawn by: JR/LM **SG-20-3-E17**  
Checked by: LM/KO

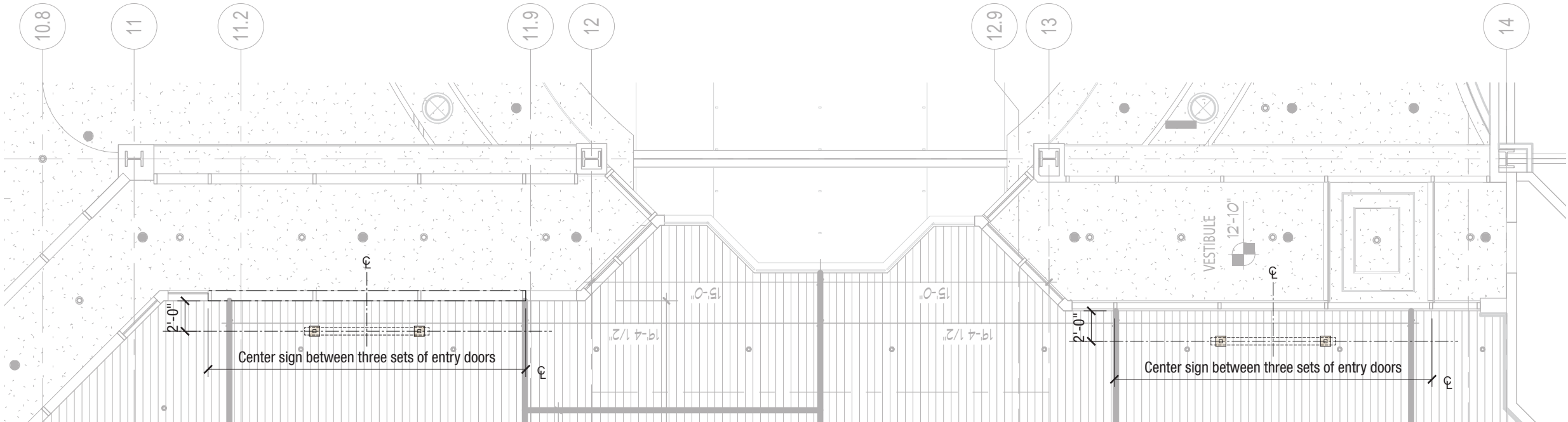

**1** RCP: Main Casino Entry  
SCALE: 1/8"=1'-0"

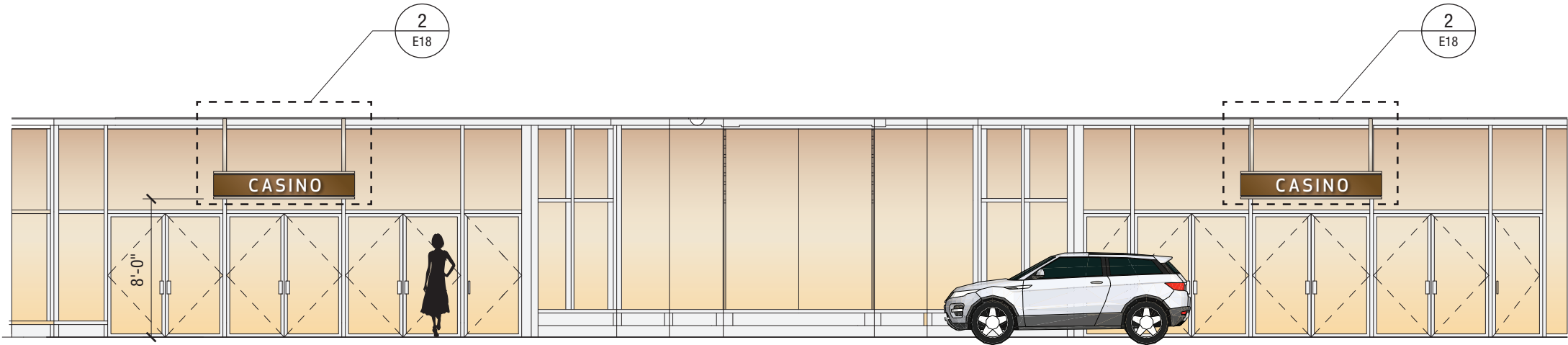

**2** ELEVATION: Main Casino Entry  
SCALE: 1/8"=1'-0"



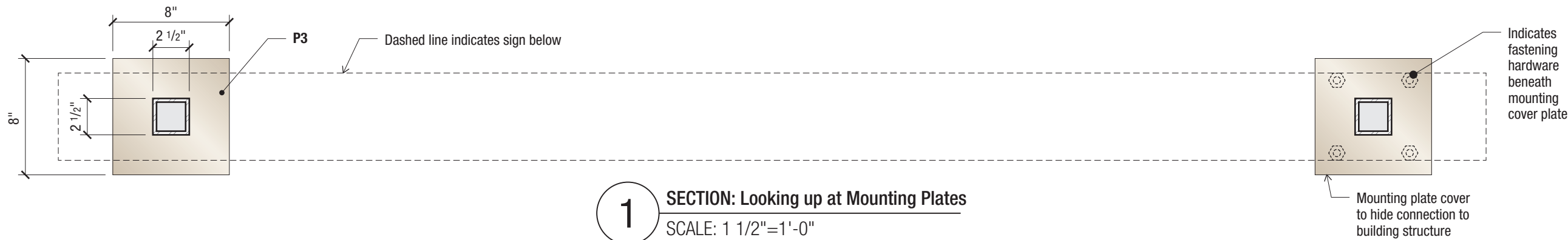

1 SECTION: Looking up at Mounting Plates  
SCALE: 1 1/2"=1'-0"

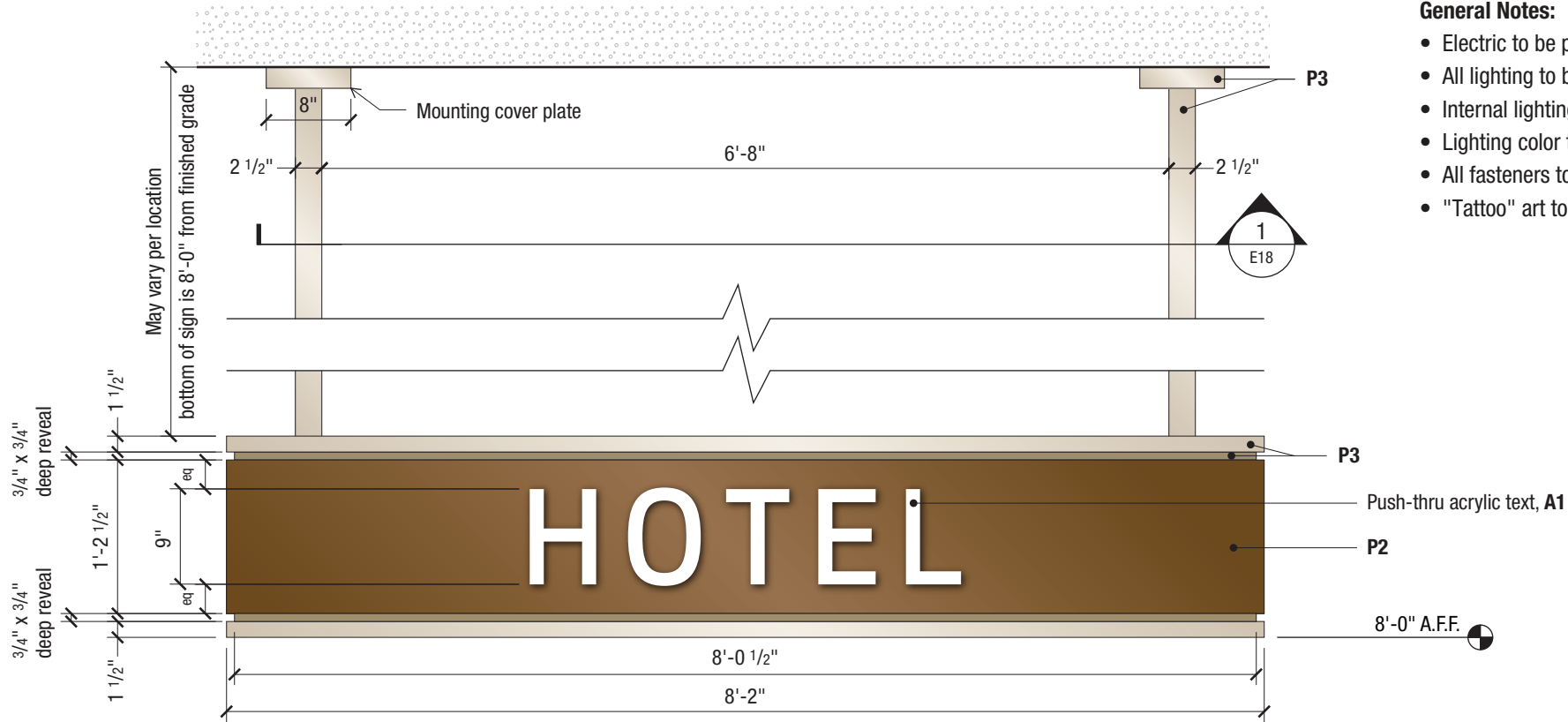

2 ELEVATION  
SCALE: 3/4"=1'-0"



3 ELEVATION: Back & Sides - Tattoo  
SCALE: 3/4"=1'-0"

General Notes:

- Electric to be pulled to locations by others. Sign Contractor is responsible for electrical hook up.
- All lighting to be internal LED with no light leaks. Vents shall be shielded to prevent light leak.
- Internal lighting to be even across all messages with no hot or cool spots.
- Lighting color temperature to be \_\_\_\_ K
- All fasteners to be hidden from view.
- "Tattoo" art to be provided by KO



4 ELEVATION  
SCALE: 3/8"=1'-0"

Push Through Acrylic

All push-through acrylic shall be cut true to the letter, glyph and symbol forms - rounded corners will not be acceptable. Push-through acrylic shall be proud of the sign panel face by no less than 1/8" and no more than 1/4"



# KIKU OBATA

Kiku Obata & Company  
6161 Delmar Blvd., Suite 200  
St. Louis, MO 63112  
Office 314.361.3110  
Fax 314.361.4716  
www.kikuobata.com

Owner:  
Hard Rock International

Client:  
SOSH Architects  
1020 Atlantic Avenue  
Atlantic City, NJ 08401  
609-345-5222

Authorized Use:  
**Bid Set**

Issue Date: February 15, 2018

Revisions:			
No.	Date	Description	Drawn By
1	-	-	
2	-	-	
3	-	-	
4	-	-	
5	-	-	
6	-	-	
7	-	-	
8	-	-	
9	-	-	
10	-	-	

All reproduction and intellectual  
property rights reserved.  
© 2018 Kiku Obata & Company

**Hard Rock Hotel & Casino**  
**Atlantic City**  
1000 Boardwalk  
Atlantic City, NJ 08401

Project Number: 2017024.00

Sign Quantity: **06**

**Type FF**  
**Building Entry ID**

Drawn by: JR/LM **SG-20-3-E18**  
Checked by: LM/KO