

OCEAN

ATLANTIC

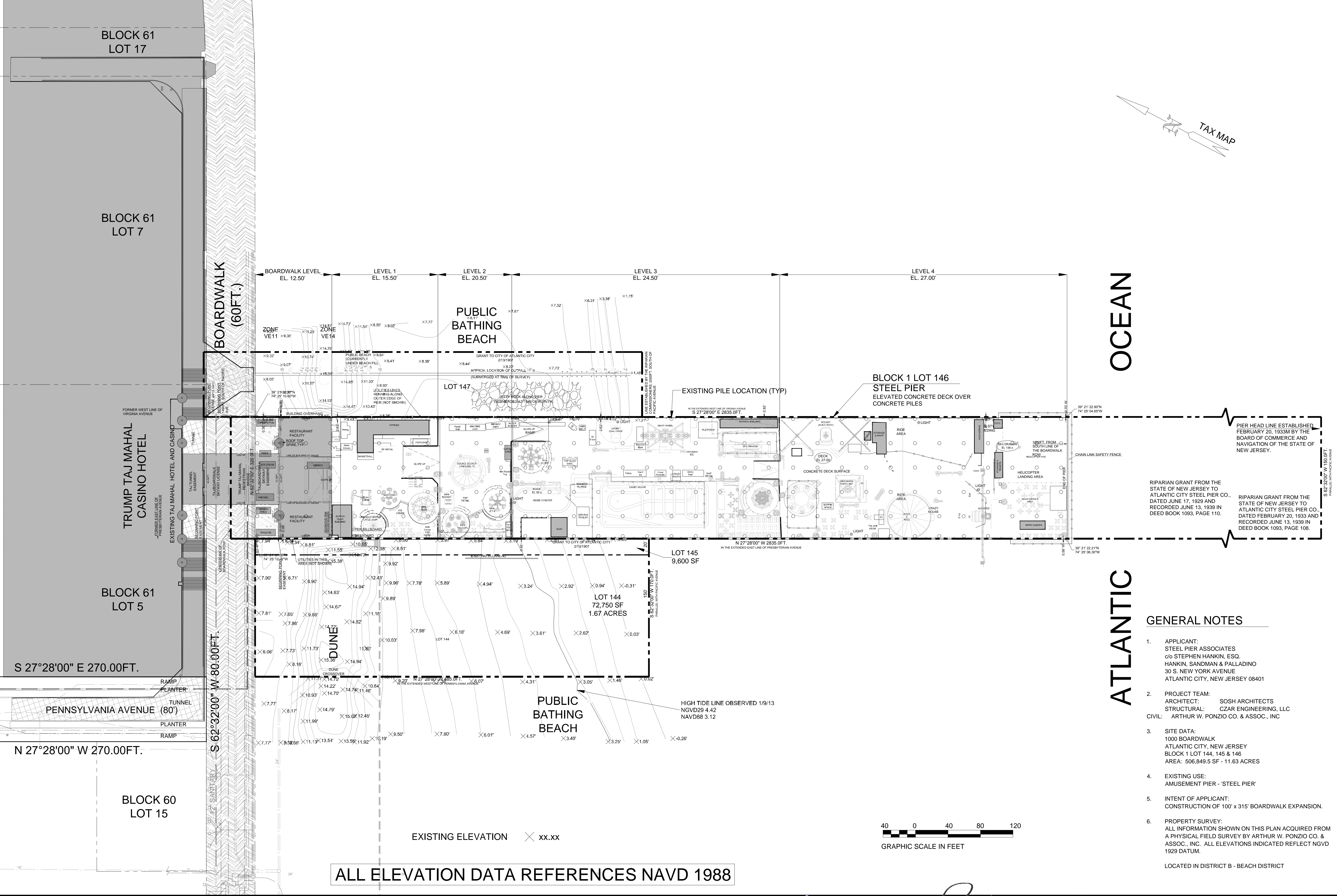

GENERAL NOTES

1. APPLICANT:
STEEL PIER ASSOCIATES
c/o STEPHEN HANKIN, ESQ.
HANKIN, SANDMAN & PALLADINO
30 S. NEW YORK AVENUE
ATLANTIC CITY, NEW JERSEY 08401
2. PROJECT TEAM:
ARCHITECT: SOSH ARCHITECTS
STRUCTURAL: CZAR ENGINEERING, LLC
CIVIL: ARTHUR W. PONZIO CO. & ASSOC., INC
3. SITE DATA:
1000 BOARDWALK
ATLANTIC CITY, NEW JERSEY
BLOCK 1 LOT 144, 145 & 146
AREA: 506,849.5 SF - 11.63 ACRES
4. EXISTING USE:
AMUSEMENT PIER - 'STEEL PIER'
5. INTENT OF APPLICANT:
CONSTRUCTION OF 100' x 315' BOARDWALK EXPANSION.
6. PROPERTY SURVEY:
ALL INFORMATION SHOWN ON THIS PLAN ACQUIRED FROM A PHYSICAL FIELD SURVEY BY ARTHUR W. PONZIO CO. & ASSOC., INC. ALL ELEVATIONS INDICATED REFLECT NAVD 1929 DATUM.
LOCATED IN DISTRICT B - BEACH DISTRICT

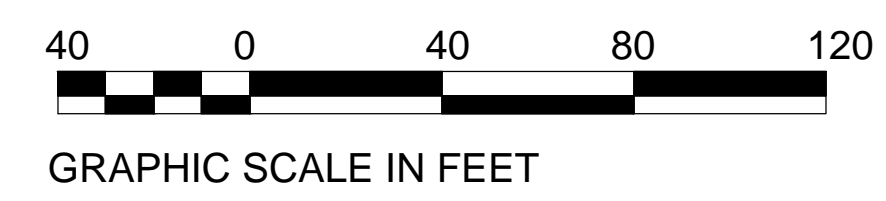

ALL ELEVATION DATA REFERENCES NAVD 1988

COPYRIGHT © 2012 ARTHUR W. PONZIO COMPANY & ASSOCIATES, INC. ALL RIGHTS RESERVED. THE COPY OR USE OF THIS DOCUMENT OR ANY PORTION THEREOF IS STRICTLY PROHIBITED WITHOUT THE WRITTEN CONSENT OF THE PREPARER. THIS DOCUMENT IS THE SOLE PROPERTY OF ARTHUR W. PONZIO COMPANY & ASSOCIATES, INC. AND HAS BEEN PREPARED SPECIFICALLY FOR USE BY THE OWNER OR CLIENT OF THIS PROJECT AT THIS SITE. IT SHOULD NOT BE USED BY ANY OTHER PERSON OR ENTITY AND MAY NOT BE COPIED IN ANY WAY FOR ANY OTHER PURPOSE AT ANY TIME.

ARTHUR W. PONZIO CO. & ASSOCIATES, INC.
SURVEYORS, PLANNERS, ENGINEERS
400 NORTH DOVER AVENUE, ATLANTIC CITY, N. J. 08401
PHONE: 609-344-8194 FAX: 609-344-1594
NEW JERSEY STATE AUTH. NO.: 24GA28001300

NO.	DATE	BY	DESCRIPTION	NO.	DATE	BY	DESCRIPTION
04	7/3/14	TAD	REV PER CRDA REVIEW				
03	5/20/14	ITAD	REV PER CRDA REVIEW				
02	1/23/13	TAD	REV PER CRDA REVIEW				
01	11/12/13	TAD	REV PER CRDA REVIEW				

THOMAS A. DASE
PROFESSIONAL PLANNER N.J. NO. 33L100625100
PROFESSIONAL ENGINEER N.J. NO. GE48387

ARTHUR W. PONZIO, JR.
PROFESSIONAL PLANNER N.J. NO. 2676
PROFESSIONAL LAND SURVEYOR N.J. NO. 28314

SURVEY & EXISTING CONDITIONS PLAN
BLOCK 1 LOT 144, 145 & 146
ATLANTIC CITY ATLANTIC COUNTY NEW JERSEY
SCALE: 1" = 40'
DATE: 8/7/13
BY: T DASE
PROJ. NO.: 30985