

HANDICAPPED RAMP W/ DETECTABLE WARNINGS

N.T.S.

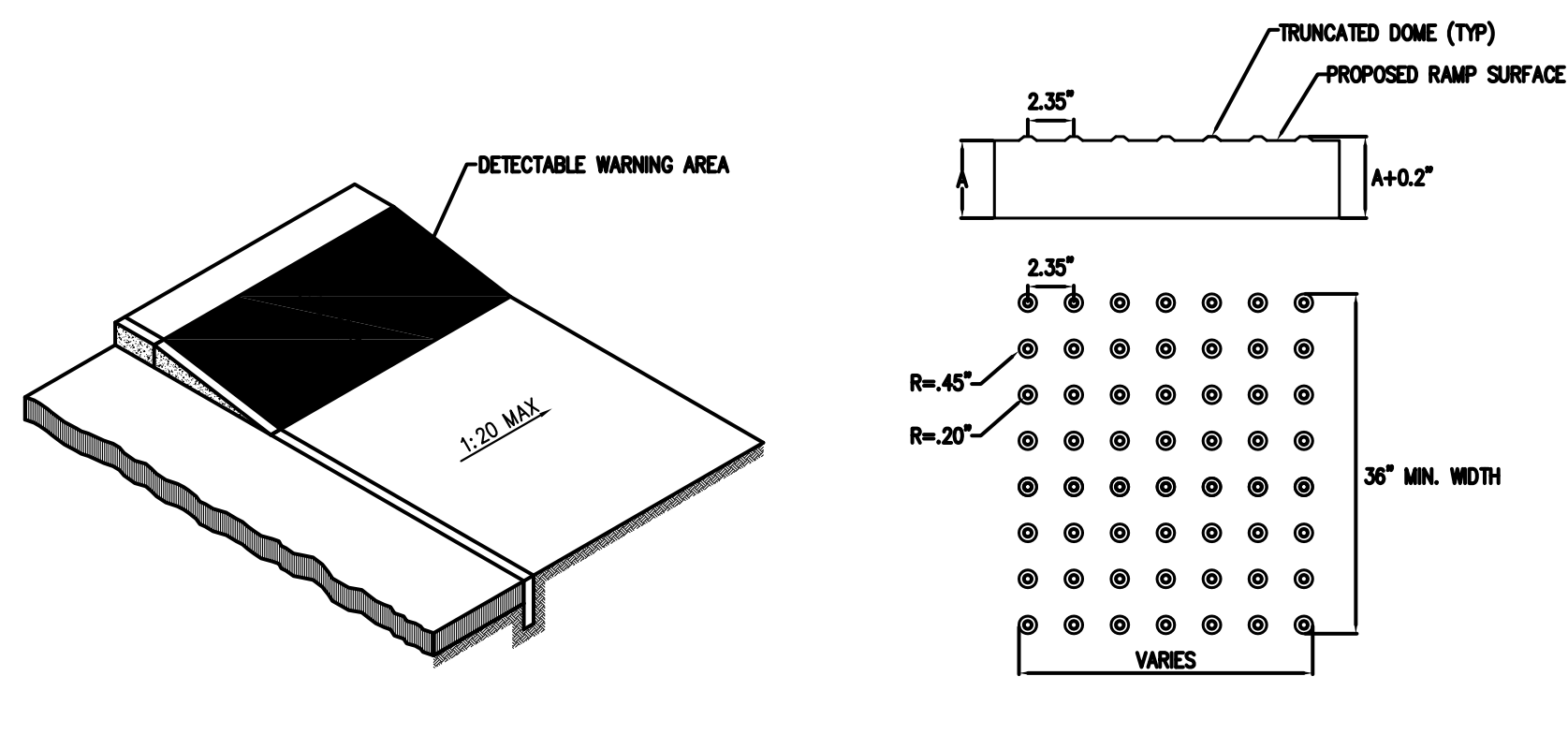

Handicapped Ramp Detail w/ Detectable Warnings

NOT TO SCALE

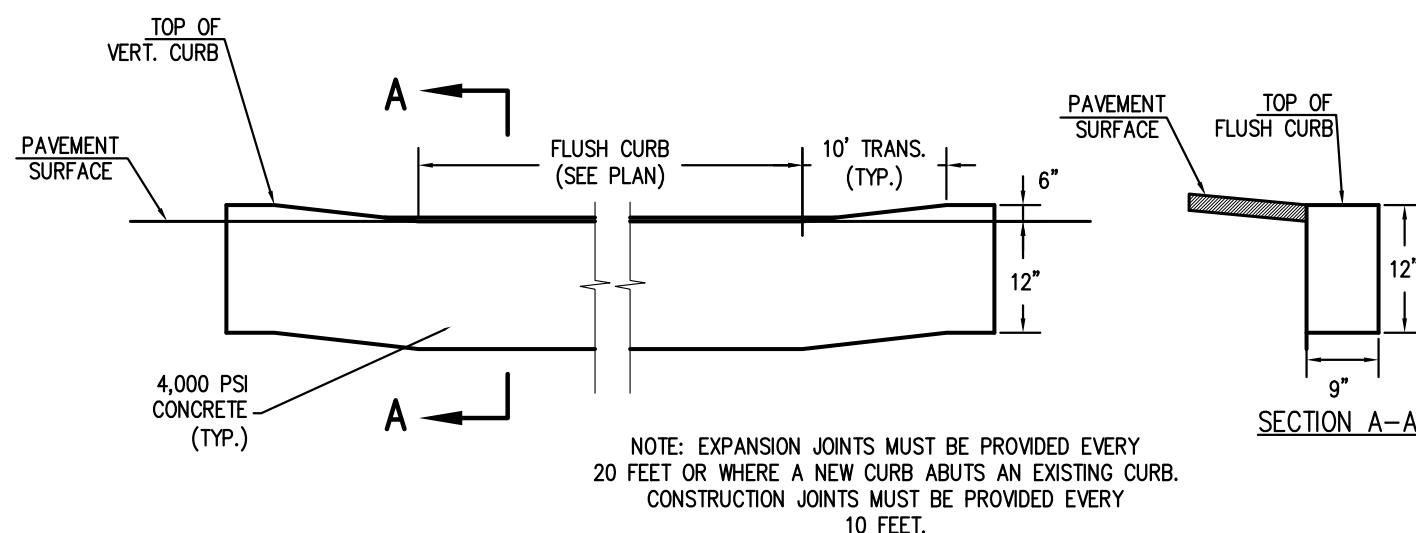

FLUSH CONCRETE CURB

NOT TO SCALE

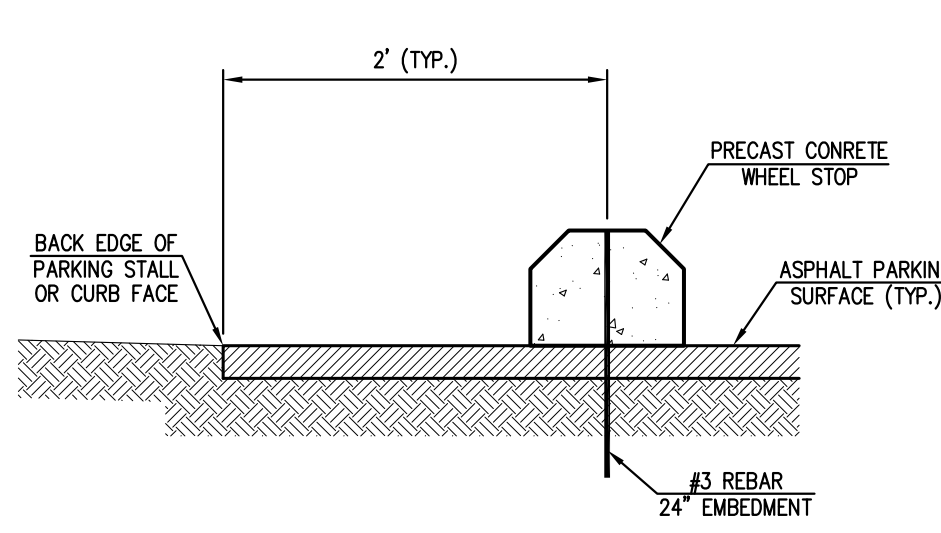

CONCRETE WHEEL STOP

NOT TO SCALE

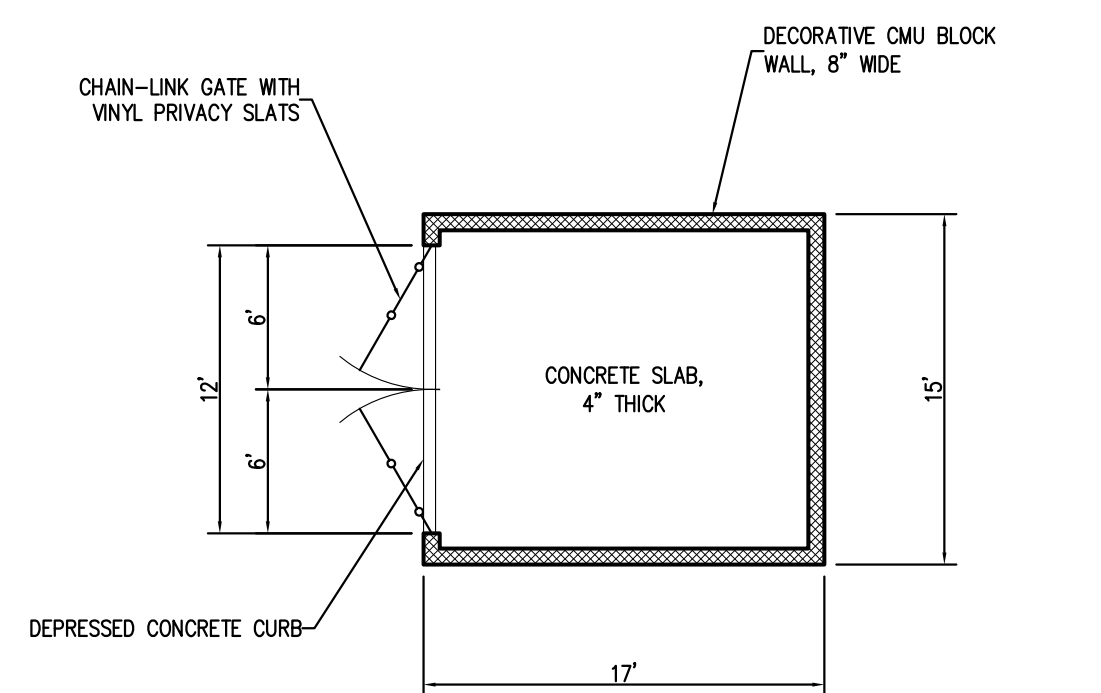

Trash Enclosure Detail

Not to Scale

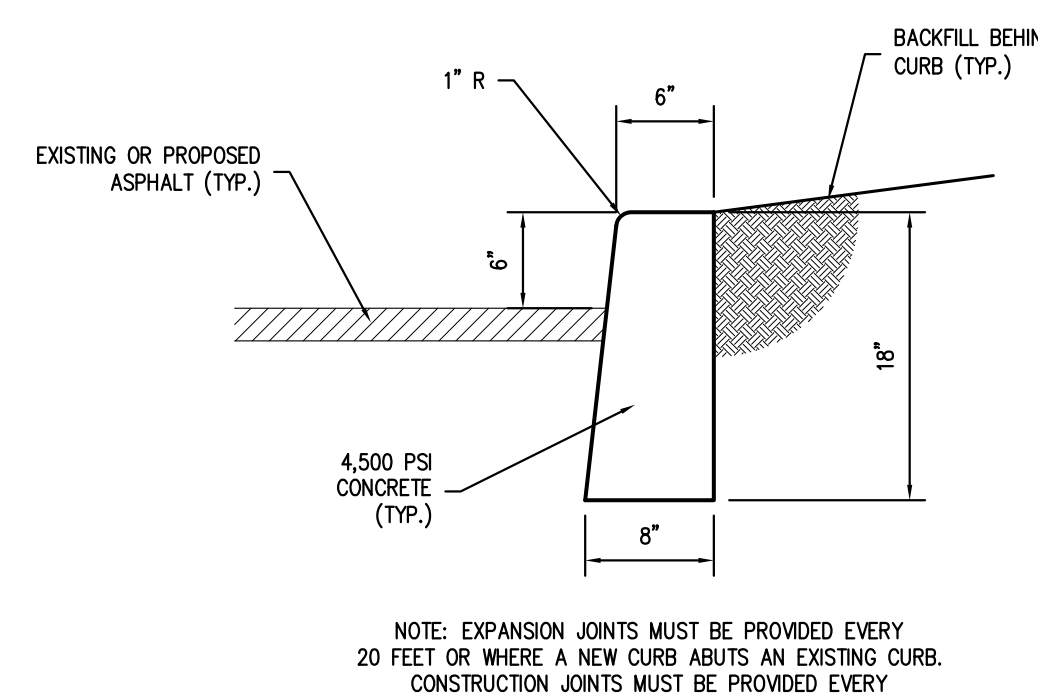

CONCRETE CURB

NOT TO SCALE

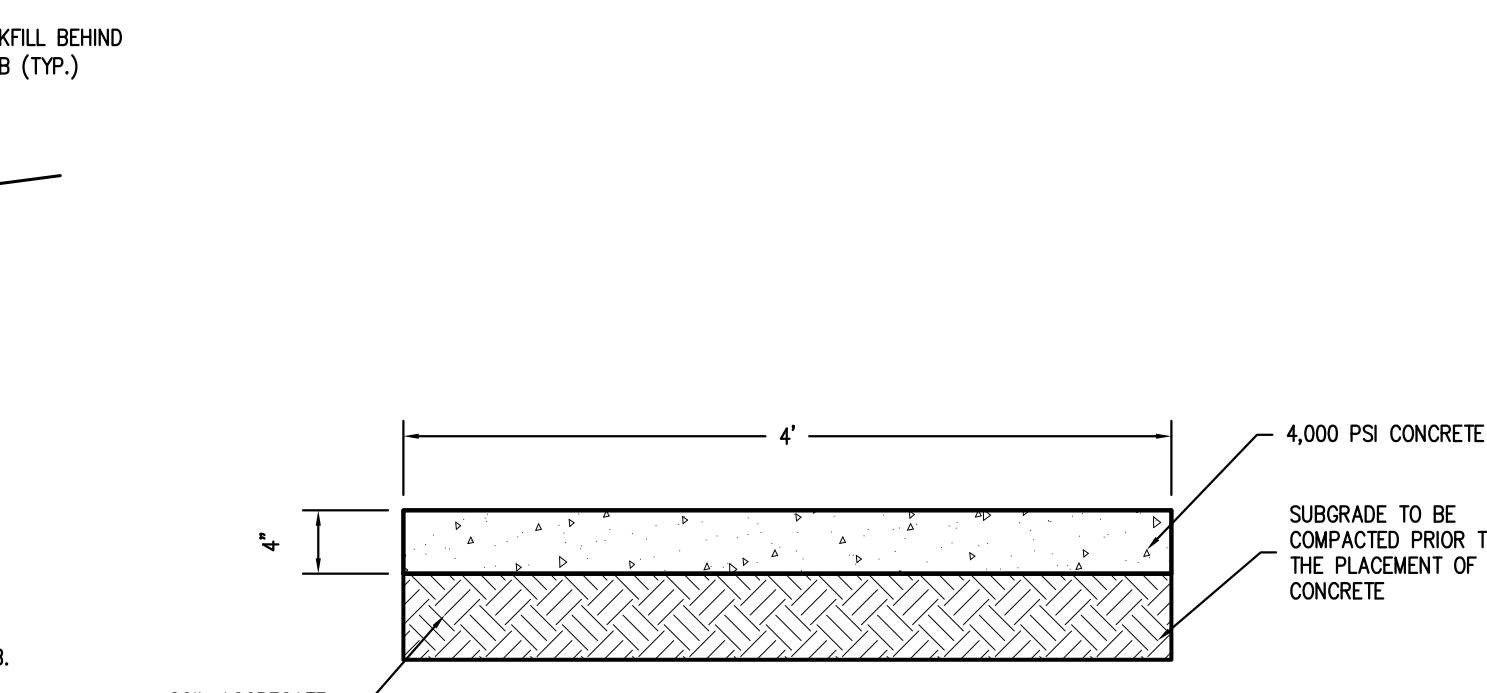

Concrete Sidewalk

NOT TO SCALE

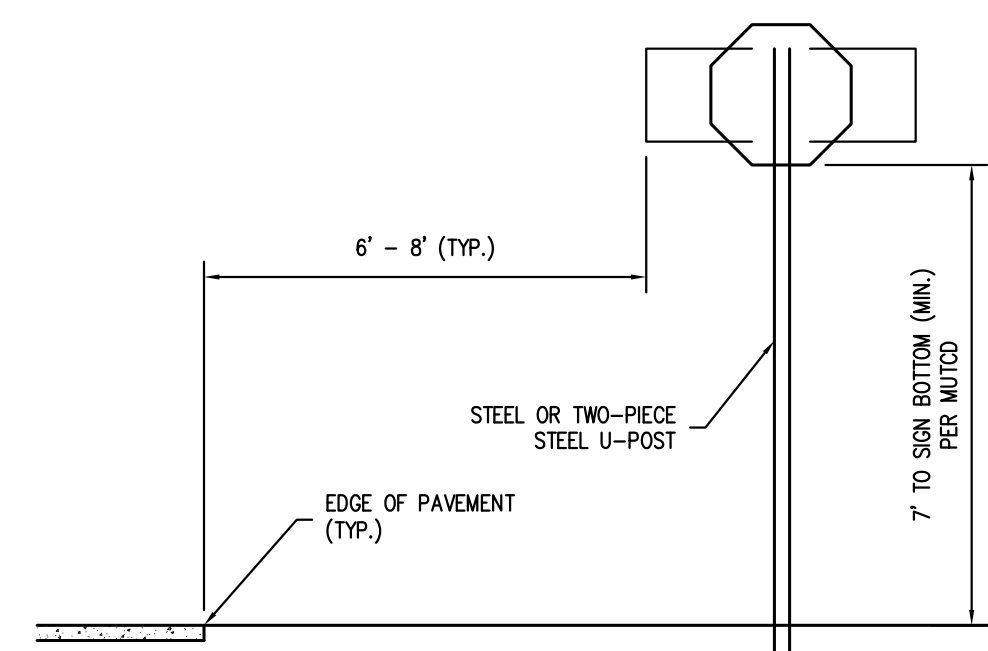

- GENERAL NOTES:**
1. ALL POSTS SHALL BE OF ADEQUATE LENGTH TO MEET THE REQUIREMENTS FOR ERECTION AS STATED IN THE CURRENT MANUAL OF UNIFORM TRAFFIC CONTROL DEVICES FOR STREETS AND HIGHWAYS.
 2. TWO PIECE STEEL POST SHALL BE EMBEDDED 4"-2" MIN. ONE PIECE ALUMINUM OR STEEL POST SHALL BE EMBEDDED 3"-6" MAX.
 3. ALL STEEL POSTS AND BRACKETS SHALL BE CUT, BENT AND HOLES PUNCHED AND DRILLED BEFORE GALVANIZING. GALVANIZING SHALL BE IN CONFORMANCE WITH CURRENT A.S.T.M. SPECIFICATIONS A 123.
 4. POSTS MAY BE STEEL, ALUMINUM OR 2 PIECE U-POST IN CONFORMANCE WITH N.J.D.O.T. STANDARD ROADWAY CONSTRUCTION DETAILS.
 5. SIGN PANEL SIZES SHALL DETERMINE POST TYPE AND NUMBER AS SHOWN ON THIS DETAIL.
 6. ADJACENT STEEL POSTS SHALL NOT BE CLOSER THAN 8 FT. APART. ADJACENT POSTS CLOSER THAN 8 FT APART SHALL BE ALUMINUM OR 2 PIECE STEEL U-POSTS. NO MORE THAN 3 ALUMINUM OR 3- TWO PIECE STEEL U-POSTS WILL BE PERMITTED WITHIN 8 FT.
 7. BOLTS SHALL NOT PROTRUDE MORE THAN 3/4" BEYOND THE NUT WHEN TIGHT BUT SHALL ENGAGE ALL THREADS IN THE NUT.

Typical Sign Mounting Detail

Not to Scale

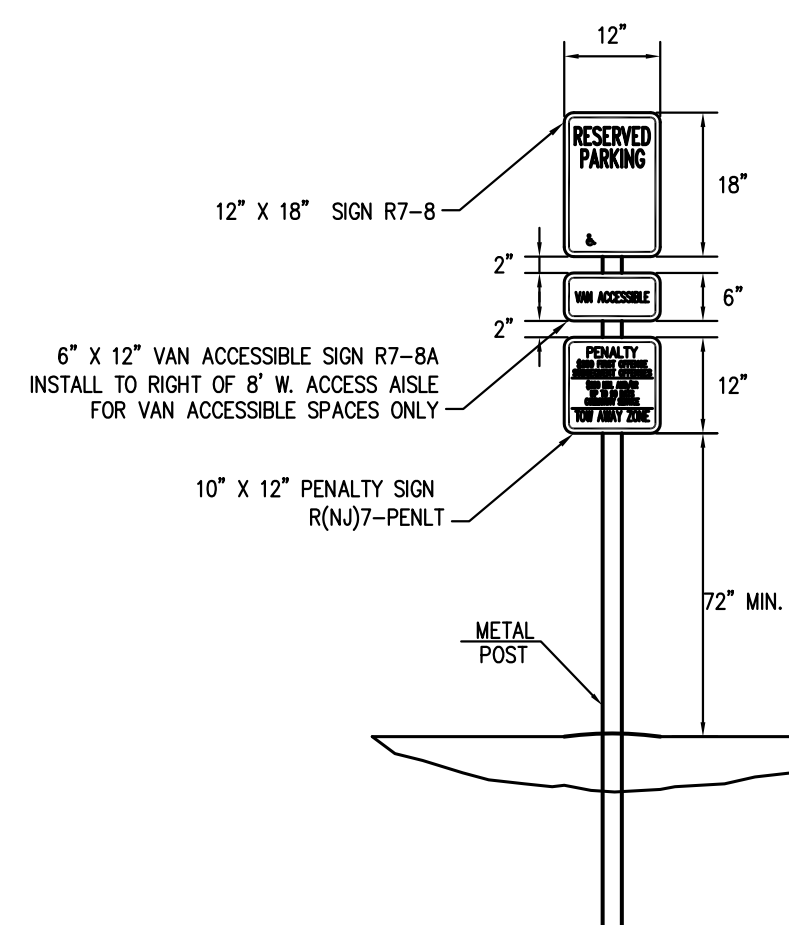

HANDICAPPED PARKING SIGN

NOT TO SCALE

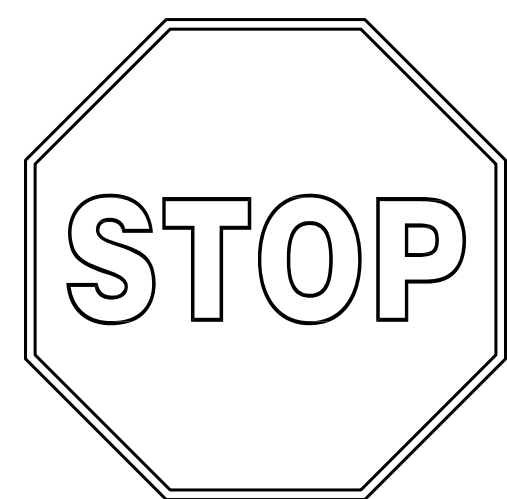

R1-1

30" x 30"
N.T.S.

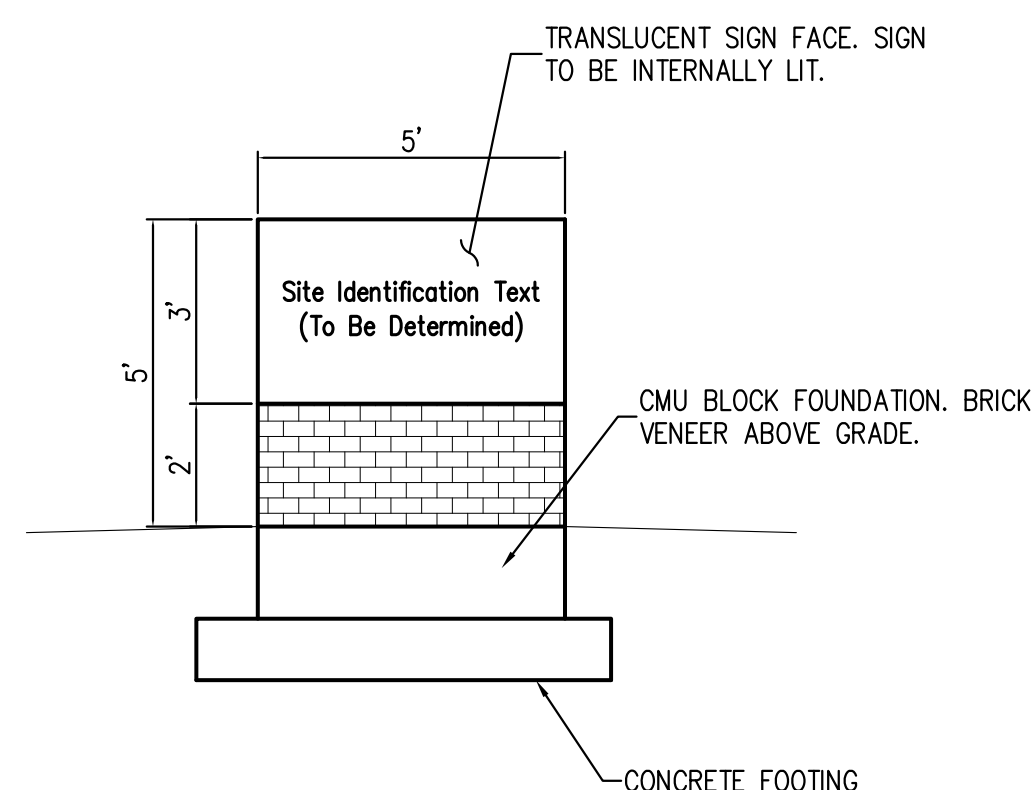

Site Identification Sign

Not to Scale

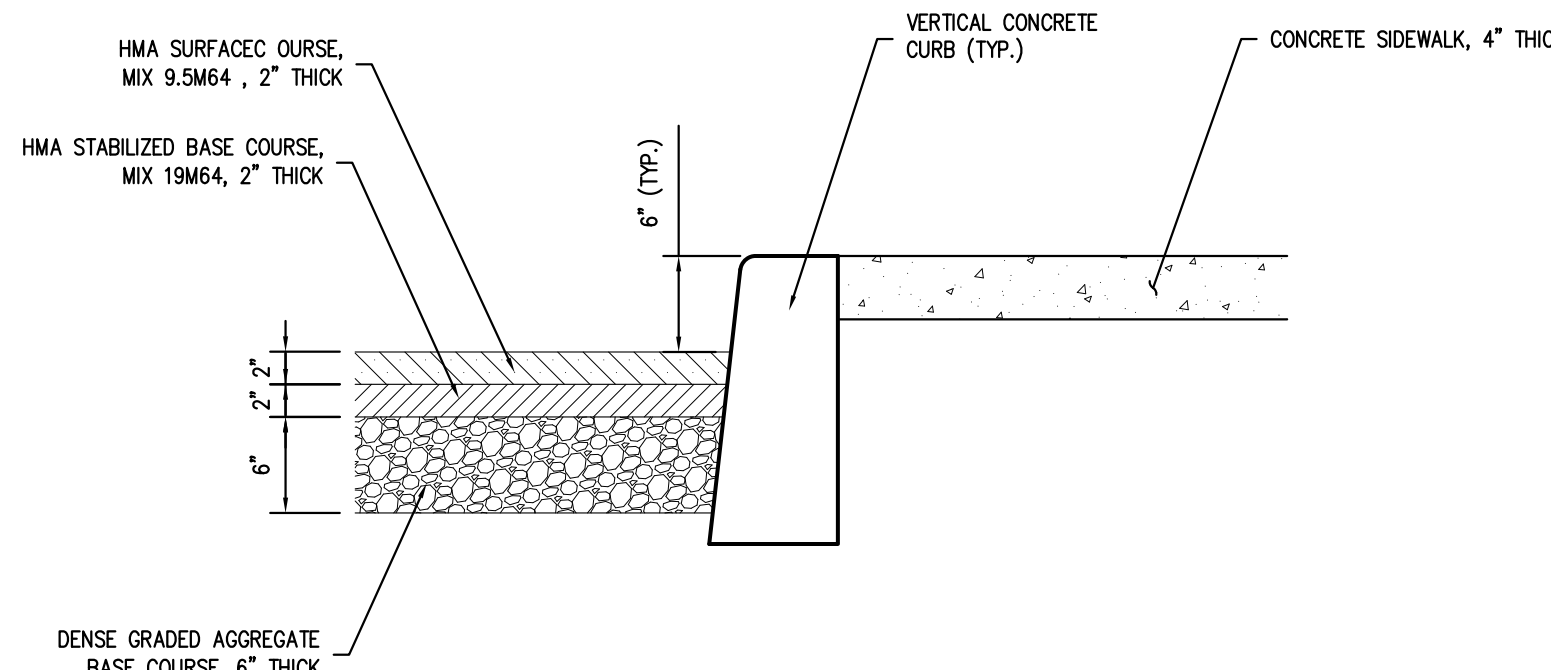

Parking Lot Pavement Detail

Not to Scale

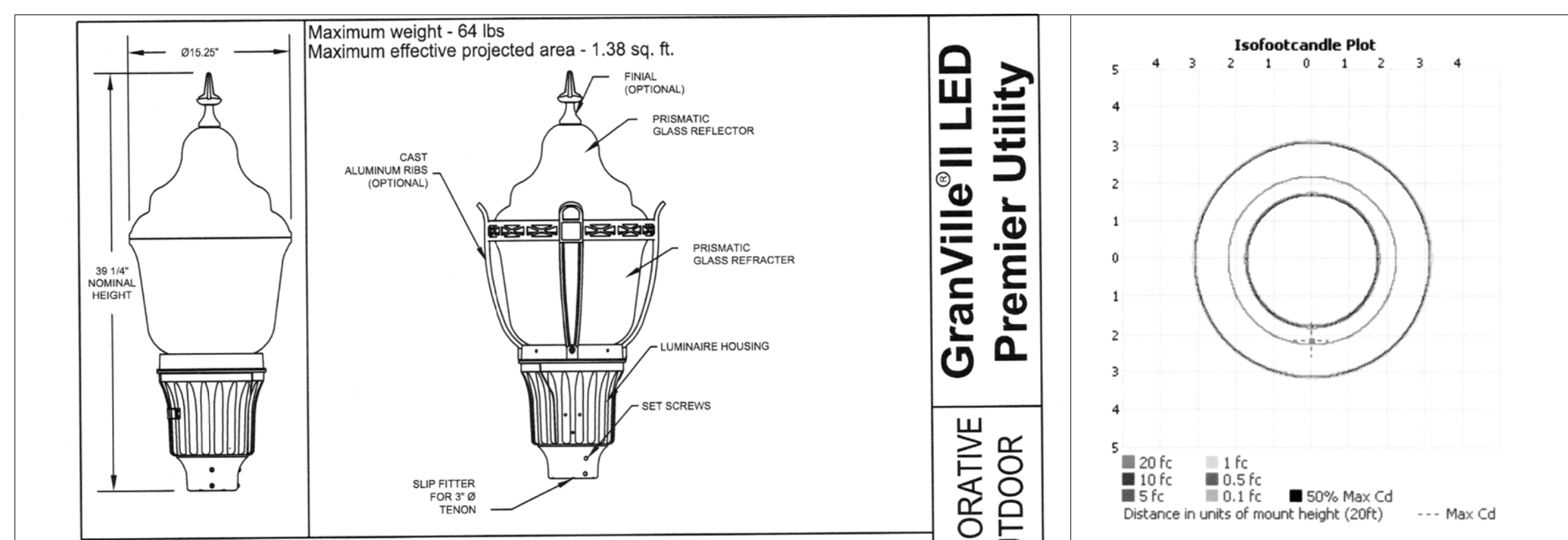

GranVille II LED

GranVille II LED
PREMIER UTILITY

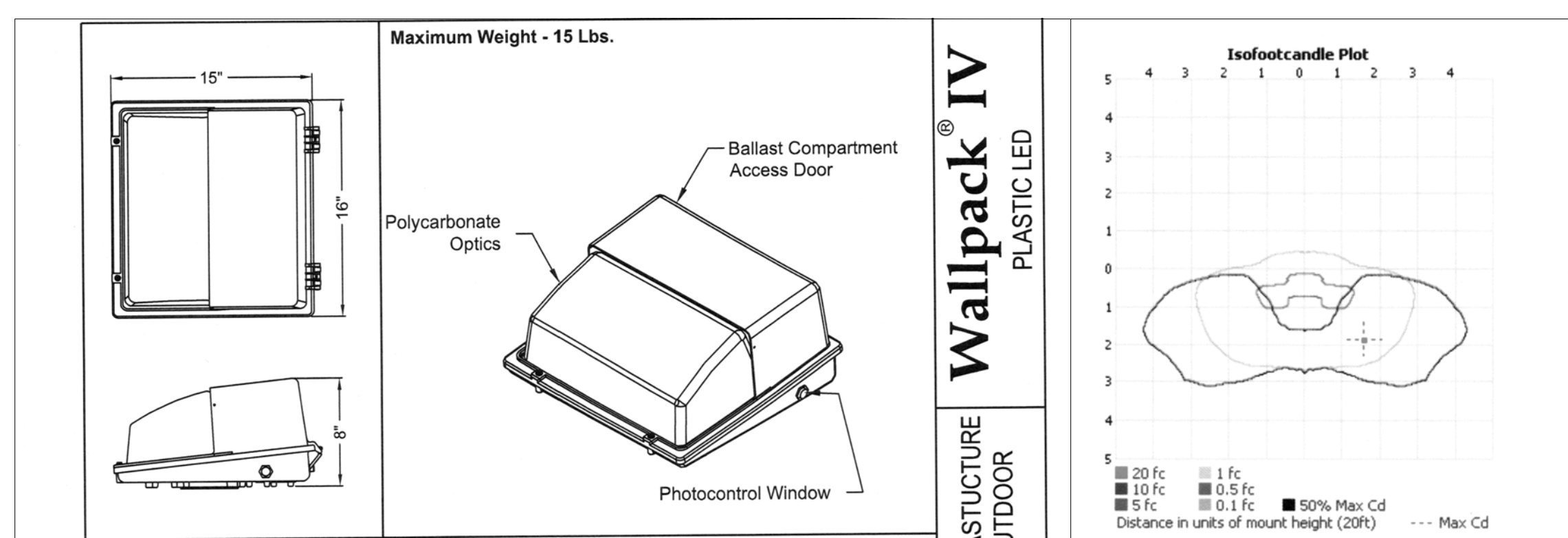
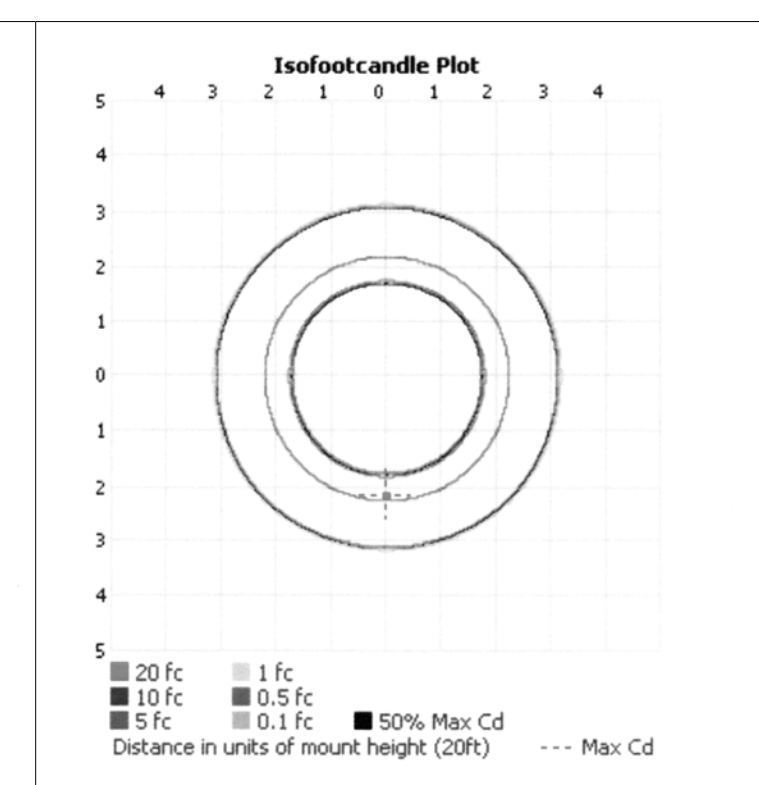

WallPack IV LED

Wallpack IV LED
PLASTIC LED

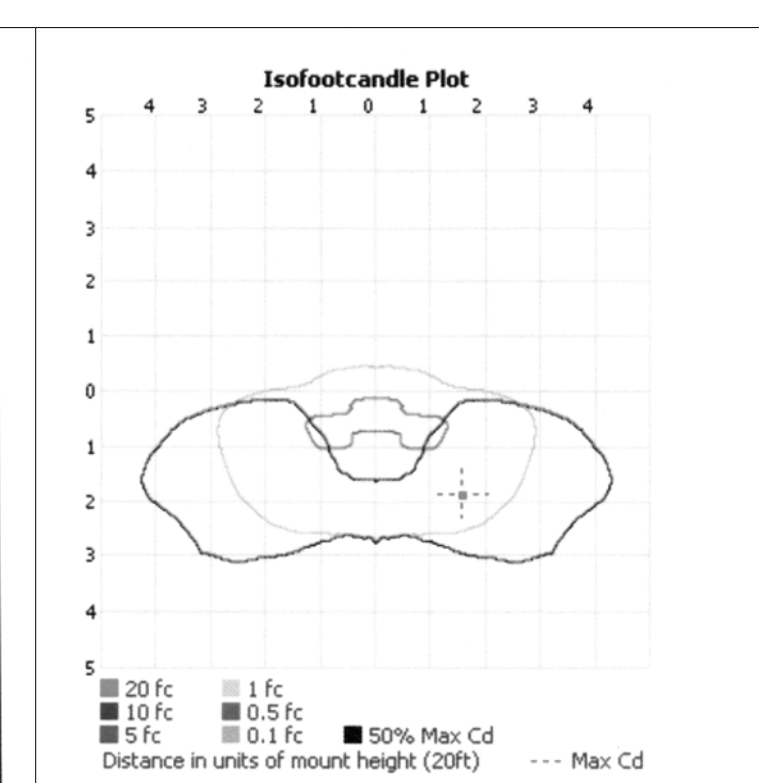

Lighting Details

Not to Scale

By	
Revision	
Date	

New Jersey State Board of Professional Engineers and Land Surveyors Certificate of Authorization
Endicott Engineering, LLC
I hereby certify that the design, calculation, and/or construction of this work was done by or under the direct supervision and control of the person(s) whose name(s) is/are printed on this certificate.

Charles E. Endicott
Professional Engineer
New Jersey License No. 41933

Designed	CEE
Drawn	STAFF
Checked	CEE
Approved	CEE

Endicott Engineering
319 E. Jimmie Leeds Road, Suite 701
Galloway, NJ 08205
Phone (609) 652-8350 Fax (609) 652-8359
e-mail: office@endicottengineering.com
www.endicottengineering.com

City of Atlantic City, Atlantic County, New Jersey
Application for Preliminary & Final Major Site Plan Approval for
JTD Realty Group, Inc.
Block 336, Lots 2-23 - 2231, Arctic Avenue
Construction Details 1

Scale	Date
As Noted	03-24-15
Sheet Name	Job No.
C8	5414.047
EE Dwg No.	
EE-3420-CD	

9
Sheet No.
Total Sheets
10

15414.047...100-base.dwg